

120 Sprockets

1 1/2" Pitch

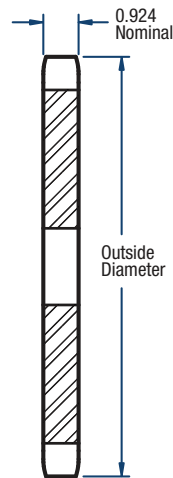
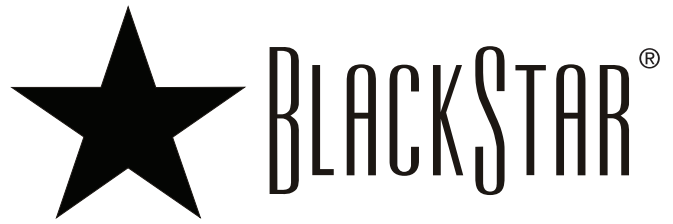

TYPE A

Single- Type A

No. of Teeth	Catalog Number	Diameters (in)		Stock Bore (in)	Approx. Weight (lbs)
		Outside	Pitch		
8	H120A8	4.52	3.920	1-1/4	2.4
9	H120A9	5.02	4.386	1-1/4	3.0
10	H120A10	5.52	4.854	1-1/4	3.8
11	H120A11	6.01	5.325	1-1/4	4.8
12	H120A12	6.50	5.796	1-1/4	5.8
13	H120A13	6.99	6.269	1-1/4	6.7
14	H120A14	7.47	6.741	1-1/4	8.0
15	H120A15	7.96	7.215	1-1/4	9.1
16	H120A16	8.44	7.689	1-1/4	10.6
17	H120A17	8.92	8.163	1-1/4	12.6
18	H120A18	9.41	8.639	1-1/4	13.6
19	H120A19	9.89	9.114	1-1/4	15.1
20	H120A20	10.37	9.588	1-1/4	16.9
21	H120A21	10.85	10.065	1-1/4	18.7
22	H120A22	11.33	10.541	1-1/4	20.0
23	H120A23	11.81	11.016	1-1/4	22.1
24	H120A24	12.29	11.492	1-1/4	24.8
25	H120A25	12.77	11.969	1-1/4	26.8

No. of Teeth	Catalog Number	Diameters (in)		Stock Bore (in)	Approx. Weight (lbs)
		Outside	Pitch		
26	H120A26	13.25	12.444	1-1/2	28.3
27	H120A27	13.73	12.921	1-1/2	30.9
28	H120A28	14.21	13.397	1-1/2	33.6
30	H120A30	15.17	14.351	1-1/2	39.0
32	120A32	16.13	15.303	1-1/2	43.9
33	120A33	16.61	15.780	1-1/2	48.2
34	120A34	17.09	16.257	1-1/2	50.0
35	120A35	17.57	16.734	1-1/2	52.0
36	120A36	18.05	17.211	1-1/2	56.0
40	120A40	19.96	19.119	1-1/2	71.0
42	120A42	20.92	20.073	1-1/2	75.0
45	120A45	22.35	21.504	1-1/2	88.0
48	120A48	23.79	22.935	1-1/2	103.0
54	120A54	26.65	25.797	1-1/2	140.0
60	120A60	29.52	28.661	1-1/2	160.0
70	120A70	34.30	33.434	1-1/2	216.0
80	120A80	39.08	38.207	1-1/2	284.0
90	120A90	43.85	42.981	1-1/2	358.0

Sprockets with "H" prefix have hardened teeth.

NOTE: Maximum bores shown will accommodate a standard keyseat and a setscrew over the keyseat. Slightly larger bores are possible with no keyseat, a shallow keyseat, or a setscrew at an angle to the keyseat.