

# 120 Sprockets

## 1 1/2" Pitch

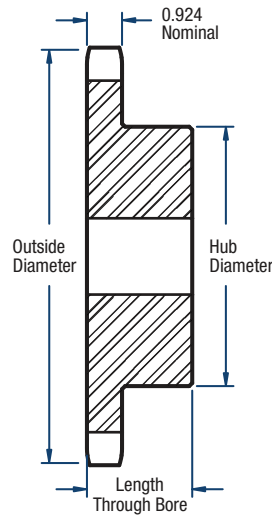

# BLACKSTAR®



**TYPE B**

### Single- Type B

No. of Teeth	Catalog Number	Diameters (in)		Bore (in)		Hub (in)		Approx. Weight (lbs)
		Outside	Pitch	Min.	Max.	Diameter	Length Through Bore	
9	H120B9	5.02	4.386	1-3/8	1-13/16	3-3/8*	2-1/4	5.3
10	H120B10	5.52	4.854	1-3/8	2-1/4	3-3/4*	2-1/4	7.1
11	H120B11	6.01	5.325	1-3/8	2-3/8	3-9/16	2-1/8	7.6
12	H120B12	6.50	5.796	1-3/8	2-3/4	4-1/8	2-1/8	9.9
13	H120B13	6.99	6.269	1-3/8	3	4-9/16	2-1/4	12.4
14	H120B14	7.47	6.741	1-3/8	3-1/4	4-3/4	2-1/4	14.4
15	H120B15	7.96	7.215	1-1/4	3-1/4	4-3/4	2-3/8	16.7
16	H120B16	8.44	7.689	1-1/4	3-1/2	5-1/4	2-3/8	19.9
17	H120B17	8.92	8.163	1-1/4	3-1/2	5-1/4	2-3/8	20.8
18	H120B18	9.41	8.639	1-1/4	3-1/2	5-1/4	2-3/8	22.2
19	H120B19	9.89	9.114	1-1/4	3-1/2	5-1/4	2-3/8	24.8
20	H120B20	10.37	9.588	1-1/4	3-1/2	5-1/4	2-3/8	25.8
21	H120B21	10.85	10.065	1-1/4	3-1/2	5-1/4	2-3/8	26.7
22	H120B22	11.33	10.541	1-1/4	3-1/2	5-1/4	2-3/8	28.2
23	H120B23	11.81	11.016	1-1/4	3-1/2	5-1/4	2-3/8	30.3
24	H120B24	12.29	11.492	1-1/4	3-1/2	5-1/4	2-3/8	32.1
25	H120B25	12.77	11.969	1-1/4	3-1/2	5-1/4	2-3/8	34.6
26	H120B26	13.25	12.444	1-1/2	4	6	2-1/2	40.0
28	H120B28	14.21	13.397	1-1/2	4	6	2-1/2	44.9
30	H120B30	15.17	14.351	1-1/2	4	6	2-1/2	50.2
32	120B32	16.13	15.303	1-1/2	4	6	2-1/2	56.0
35	120B35	17.57	16.734	1-1/2	4	6	2-1/2	62.4
36	120B36	18.05	17.211	1-1/2	4	6	2-1/2	66.4

\*Has a recessed groove in the hub for chain clearance.  
Sprockets with "H" prefix have hardened teeth.

**NOTE:** Maximum bores shown will accommodate a standard keyseat and a setscrew over the keyseat. Slightly larger bores are possible with no keyseat, a shallow keyseat, or a setscrew at an angle to the keyseat.