

120 Sprockets

1 1/2" Pitch

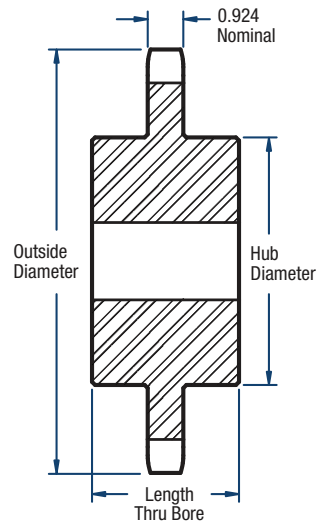

BLACKSTAR[®]



TYPE C

Single- Type C

No. of Teeth	Catalog Number	Diameters (in)		Bore (in)		Hub (in)		Approx. Weight (lbs)
		Outside	Pitch	Minimum	Maximum	Diameter	Length Through Bore	
11	H120C11	6.01	5.325	1 3/8	2 3/8	3 9/26	3 3/8	12.5
12	H120C12	6.50	5.796	1 3/8	2 3/4	4 13/16	3 3/8	14.8
13	H120C13	6.99	6.269	1 3/8	3	4 5/8	3 3/8	17.2
14	H120C14	7.47	6.741	1 3/8	3 1/4	4 3/4	3 3/8	19.5
40	120C40	19.96	19.119	1-1/2	4	6	3-3/4	92.0
42	120C42	20.92	20.073	1-1/2	4	6	3-3/4	98.0
45	120C45	22.35	21.504	1-1/2	4	6	3-3/4	99.2
48	120C48	23.79	22.935	1-1/2	4	6	4	113.0
54	120C54	26.65	25.797	1-1/2	4	6	4	133.0
60	120C60	29.52	28.661	1-1/2	5-1/4	7	4	160.0
70	120C70	34.30	33.434	1-1/2	5-3/8	7-1/2	4-1/2	206.0
80	120C80	39.08	38.207	1-1/2	5-3/8	7-1/2	4-1/2	254.0

NOTE: Maximum bores shown will accommodate a standard keyseat and a setscrew over the keyseat. Slightly larger bores are possible with no keyseat, a shallow keyseat, or a setscrew at an angle to the keyseat.