

# 120 Sprockets

## 1 1/2" Pitch

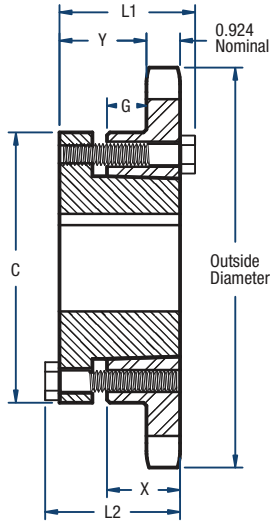

BLACKSTAR®



TYPE B

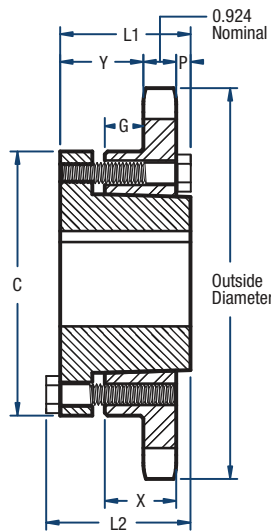

TYPE B1

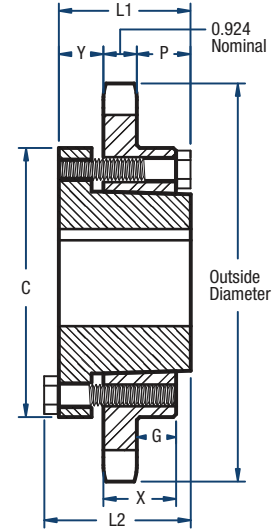

TYPE C

### Single- QD Style

No. of Teeth	Catalog Number	Bushing	Diameters (in)		Type	Max. Bore	Dimensions (in)							Approx. Weight (lbs)	
			Outside	Pitch			L1	L2	C	Y	P	G	X	Bushing Only	Sprocket Only
12	H120SF12	SF	6.50	5.796	B	2-15/16	2-1/4	2-1/4	4-5/8	1-5/64	—	21/64	1-1/4	3.0	4.7
13	H120SF13	SF	6.99	6.269	B	2-15/16	2-1/4	2-1/4	4-5/8	1-5/64	—	21/64	1-1/4	3.0	6.1
14	H120SF14	SF	7.47	6.741	B	2-15/16	2-1/4	2-1/4	4-5/8	1-5/64	—	21/64	1-1/4	3.0	7.4
15	H120SF15	SF	7.96	7.215	B	2-15/16	2-1/4	2-1/4	4-5/8	1-5/64	—	21/64	1-1/4	3.0	8.0
16	H120E16	E	8.44	7.689	B1	3-1/2	2-5/8	2-15/16	6	1-9/16	1/8	45/64	1-5/8	10.0	11.2
17	H120E17	E	8.92	8.163	B1	3-1/2	2-5/8	2-15/16	6	1-9/16	1/8	45/64	1-5/8	10.0	13.4
18	H120E18	E	9.41	8.639	B1	3-1/2	2-5/8	2-15/16	6	1-9/16	1/8	45/64	1-5/8	10.0	14.8
19	H120E19	E	9.89	9.114	B1	3-1/2	2-5/8	2-15/16	6	1-9/16	1/8	45/64	1-5/8	10.0	16.5
20	H120E20	E	10.37	9.588	B1	3-1/2	2-5/8	2-15/16	6	1-9/16	1/8	45/64	1-5/8	10.0	19.2
21	H120E21	E	10.85	10.065	B1	3-1/2	2-5/8	2-15/16	6	1-9/16	1/8	45/64	1-5/8	10.0	19.9
22	H120E22	E	11.33	10.541	B1	3-1/2	2-5/8	2-15/16	6	1-9/16	1/8	45/64	1-5/8	10.0	21.6
23	H120E23	E	11.81	11.016	B1	3-1/2	2-5/8	2-15/16	6	1-9/16	1/8	45/64	1-5/8	10.0	23.8
24	H120E24	E	12.29	11.492	B1	3-1/2	2-5/8	2-15/16	6	1-9/16	1/8	45/64	1-5/8	10.0	25.8
25	H120E25	E	12.77	11.969	B1	3-1/2	2-5/8	2-15/16	6	1-9/16	1/8	45/64	1-5/8	10.0	28.1
26	H120E26	E	13.25	12.444	B1	3-1/2	2-5/8	2-15/16	6	1-9/16	1/8	45/64	1-5/8	10.0	29.9
28	H120E28	E	14.21	13.397	B1	3-1/2	2-5/8	2-15/16	6	1-9/16	1/8	45/64	1-5/8	10.0	34.7
30	H120E30	E	15.17	14.351	B1	3-1/2	2-5/8	2-15/16	6	1-9/16	1/8	45/64	1-5/8	10.0	39.4
32	120F32	F	16.13	15.303	C	3-15/16	3-5/8	4	6-5/8	1	1-11/16	1-37/64	2-1/2	11.5	50.5
35	120F35	F	17.57	16.734	C	3-15/16	3-5/8	4	6-5/8	1	1-11/16	1-37/64	2-1/2	11.5	59.5
36	120F36	F	18.05	17.211	C	3-15/16	3-5/8	4	6-5/8	1	1-11/16	1-37/64	2-1/2	11.5	63.4
40	120F40	F	19.96	19.119	C	3-15/16	3-5/8	4	6-5/8	1	1-11/16	1-37/64	2-1/2	11.5	77.0
42	120F42	F	20.92	20.073	C	3-15/16	3-5/8	4	6-5/8	1	1-11/16	1-37/64	2-1/2	11.5	83.0
45	120F45	F	22.35	21.504	C	3-15/16	3-5/8	4	6-5/8	1	1-11/16	1-37/64	2-1/2	11.5	84.0
48	120F48	F	23.79	22.935	C	3-15/16	3-5/8	4	6-5/8	1	1-11/16	1-37/64	2-1/2	11.5	92.0
54	120F54	F	26.65	25.797	C	3-15/16	3-5/8	4	6-5/8	1	1-11/16	1-37/64	2-1/2	11.5	114.0
60	120J60	J	29.52	28.661	C	4-7/16	4-1/2	5	7-1/4	1-3/16	2-5/16	2-17/64	3-3/16	18.0	140.0
70	120J70	J	34.30	33.434	C	4-7/16	4-1/2	5	7-1/4	1-3/16	2-5/16	2-17/64	3-3/16	18.0	177.0
80	120J80	J	39.08	38.207	C	4-7/16	4-1/2	5	7-1/4	1-3/16	2-5/16	2-17/64	3-3/16	18.0	222.0

**NOTE:** Maximum bores shown will accommodate a standard keyseat and a setscrew over the keyseat. Slightly larger bores are possible with no keyseat, a shallow keyseat, or a setscrew at an angle to the keyseat.