

140 Sprockets

1 3/4" Pitch

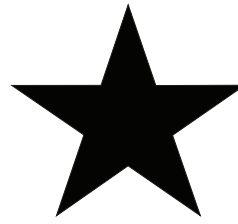

BLACKSTAR[®]

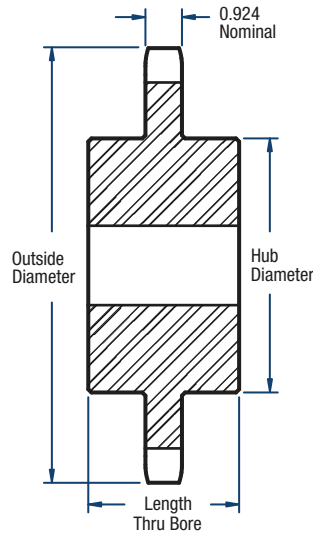

TYPE C

Single- Type C

No. of Teeth	Catalog Number	Diameters (in)		Type	Bore (in)		Hub (in)		Approx. Weight (lbs)
		Outside	Pitch		Minimum	Maximum	Diameter	Length Through Bore	
35	140C35	20.49	19.523	C	1-1/2	5-1/4	7	4	108.0
36	140C36	21.05	20.080	C	1-1/2	5-1/4	7	4	110.0
40	140C40	23.29	22.306	C	1-1/2	5-1/4	7	4	121.0
45	140C40	26.08	25.088	C	1-1/2	5-1/4	7	4	142.0
48	140C48	27.75	26.758	C	1-1/2	5-1/4	7	4	150.0
54	140C54	31.10	30.097	C	1-1/2	5-1/4	7	4	177.0
60	140C60	34.44	33.437	C	1-1/2	5-1/4	7	5	220.0
70	140C70	40.02	39.006	C	1-1/2	5-3/8	7-1/2	5	282.0
80	140C80	45.59	44.574	C	1-1/2	5-3/8	7-1/2	5	331.0

NOTE: Maximum bores shown will accommodate a standard keyseat and a setscrew over the keyseat. Slightly larger bores are possible with no keyseat, a shallow keyseat, or a setscrew at an angle to the keyseat.