

# 160 Sprockets

## 2" Pitch

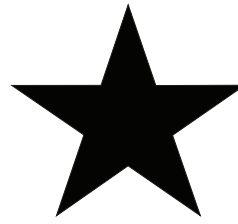

# BLACKSTAR®

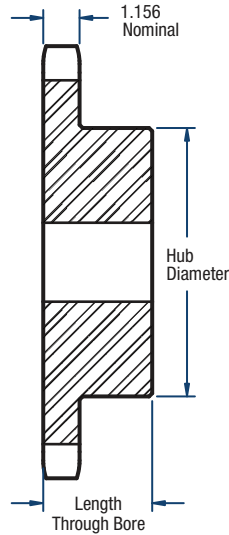

**TYPE B**

### Single- Type B

No. of Teeth	Catalog Number	Diameters (in)		Bore (in)		Hub (in)		Approx. Weight (lbs)
		Outside	Pitch	Minimum	Maximum	Diameter	Length Through Bore	
8	H160B8	6.03	5.226	1-1/2	1-7/8	3-1/4	2-1/4	8.0
9	H160B9	6.70	5.848	1-1/2	2-1/8	3-5/8	2-1/4	10.00
10	H160B10	7.36	6.472	1-1/2	2-3/4	4-1/8	2-1/4	12.00
11	H160B11	8.01	7.100	1-1/2	3-1/4	4-3/4	2-1/2	17.00
12	H160B12	8.66	7.728	1-1/2	3-3/4	5-1/2	2-1/2	21.00
13	H160B13	9.31	8.358	1-1/2	4	6	2-3/4	28.00
14	H160B14	9.96	8.988	1-1/2	4-1/2	6-1/2	2-3/4	32.00
15	H160B15	10.61	9.620	1-1/2	5-1/4	7	2-3/4	37.00
16	H160B16	11.25	10.252	1-1/2	5-1/4	7	2-3/4	41.00
17	H160B17	11.90	10.844	1-1/2	5-1/4	7	2-3/4	45.00
18	H160B18	12.54	11.518	1-1/2	5-1/4	7	2-3/4	48.00
19	H160B19	13.19	12.152	1-1/2	5-1/4	7	2-3/4	52.00
20	H160B20	13.83	12.784	1-1/2	5-1/4	7	2-3/4	56.00
21	H160B21	14.47	13.420	1-1/2	5-1/4	7	2-3/4	59.00
22	H160B22	15.11	14.054	1-1/2	5-1/4	7	2-3/4	65.00
23	H160B23	15.75	14.688	1-1/2	5-1/4	7	2-3/4	68.00
24	H160B24	16.39	15.322	1-1/2	5-1/4	7	3	77.00
25	H160B25	17.03	15.958	1-1/2	5-1/4	7	3	81.00
26	H160B26	17.67	16.592	1-1/2	5-1/4	7	3	86.00
27	H160B27	18.31	17.228	1-1/2	5-1/4	7	3	91.00
28	H160B28	18.95	17.862	1-1/2	5-1/4	7	3	98.00
30	H160B30	20.23	19.134	1-1/2	5-1/4	7	3	108.00

**NOTE:** Maximum bores shown will accommodate a standard keyseat and a setscrew over the keyseat. Slightly larger bores are possible with no keyseat, a shallow keyseat, or a setscrew at an angle to the keyseat.