

# 160 Sprockets

## 2" Pitch

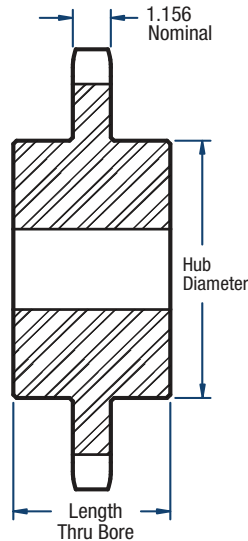

# BLACKSTAR®



**TYPE C**

### Single- Type C

No. of Teeth	Catalog Number	Diameters (in)		Bore (in)		Hub (in)		Approx. Weight (lbs)
		Outside	Pitch	Minimum	Maximum	Diameter	Length Through Bore	
11	H160C11	8.01	7.100	1-1/2	3-1/4	4-1/2	4-1/8	22.00
12	H160C12	8.66	7.728	1-1/2	3-3/4	5-1/2	4-1/8	33.00
35	160C35	23.42	22.312	1-1/2	5-1/2	8	4-1/2	154.00
40	160C40	26.61	25.492	1-1/2	5-1/2	8	4-1/2	196.00
45	160C45	29.80	28.672	1-1/2	5-1/2	8	5	234.00
54	160C54	35.54	34.396	1-1/2	5-1/2	8	5	276.00
60	160C60	39.36	38.214	1-1/2	5-1/2	8	5	329.00
70	160C70	45.73	44.578	1-1/2	5-1/2	8	5	446.00
80	160C80	52.10	50.942	1-1/2	5-1/2	8	6	612.00

**NOTE:** Maximum bores shown will accommodate a standard keyseat and a setscrew over the keyseat. Slightly larger bores are possible with no keyseat, a shallow keyseat, or a setscrew at an angle to the keyseat.