

# 200 Sprockets

## 2 1/2" Pitch

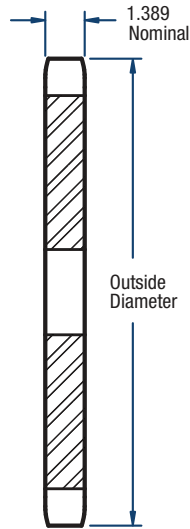

# BLACKSTAR®



**TYPE A**

### Single- Type A

No. of Teeth	Catalog Number	Diameters (in)		Stock Bore (in)	Approx. Weight (lbs)
		Outside	Pitch		
10	H200A10	9.20	8.090	1-1/2	16.0
11	H200A11	10.02	8.872	1-1/2	20.0
12	H200A12	10.83	9.660	1-1/2	24.0
13	H200A13	11.64	10.447	1-1/2	30.0
14	H200A14	12.46	11.235	1-1/2	32.0
15	H200A15	13.26	12.025	1-1/2	40.0
16	H200A16	14.07	12.815	1-1/2	46.0
17	H200A17	14.87	13.605	1-1/2	51.0
18	H200A18	15.68	14.397	1-1/2	57.0
19	H200A19	16.48	15.190	1-1/2	65.0
20	H200A20	17.29	15.980	1-1/2	72.0
21	H200A21	18.09	16.775	1-1/2	82.0
22	H200A22	18.89	17.567	1-1/2	88.0
23	H200A23	19.69	18.360	1-1/2	95.0
24	H200A24	20.49	19.153	1-1/2	105.0
25	H200A25	21.29	19.947	1-1/2	113.0
26	H200A26	22.09	20.740	1-1/2	124.0
28	H200A28	23.69	22.330	1-1/2	144.0
30	H200A30	25.29	23.917	1-1/2	167.0
32	200A32	26.88	25.505	1-1/2	195.0
35	200A35	29.28	27.890	1-1/2	227.0
40	200A40	33.27	31.865	1-1/2	301.0
45	200A45	37.25	35.840	1-1/2	390.0
54	200A54	44.42	42.995	1-1/2	555.0
60	200A60	49.20	47.768	1-1/2	692.0

**NOTE:** Maximum bores shown will accommodate a standard keyseat and a setscrew over the keyseat. Slightly larger bores are possible with no keyseat, a shallow keyseat, or a setscrew at an angle to the keyseat.