

200 Sprockets

2 1/2" Pitch

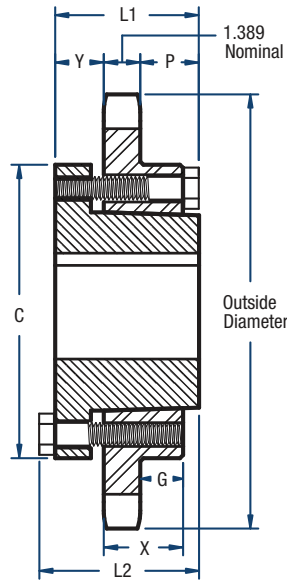

TYPE C

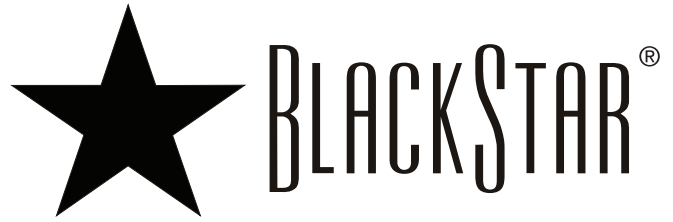
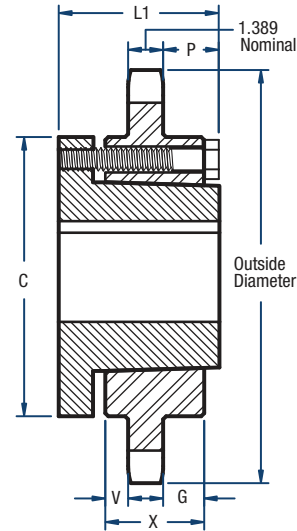

TYPE C1

Single- QD Style

No. of Teeth	Catalog Number	Bushing	Diameters (in)		Type	Max. Bore	Dimensions (in)								Approx. Weight (lbs)	
			Outside	Pitch			L1	L2	C	Y	P	G	V	X	Bushing Only	Sprocket Only
12	H200F12	F	10.83	9.660	C	3-15/16	3-5/8	4	6-5/8	1	1-5/16	1-1/8	—	2-1/2	11.5	24.0
13	H200J13	J	11.64	10.447	C	4-7/16	4-1/2	5	7-1/4	1-13/16	2	1-13/16	—	3-3/16	18.0	32.0
14	H200J14	J	12.46	11.235	C	4-7/16	4-1/2	5	7-1/4	1-13/16	2	1-13/16	—	3-3/16	18.0	39.0
15	H200J15	J	13.26	12.025	C	4-7/16	4-1/2	5	7-1/4	1-13/16	2	1-13/16	—	3-3/16	18.0	44.0
16	H200J16	J	14.07	12.815	C	4-7/16	4-1/2	5	7-1/4	1-13/16	2	1-13/16	—	3-3/16	18.0	50.0
17	H200M17	M	14.87	13.605	C1	5-1/2	6-3/4	6-3/4	9	2-23/32	2-23/32	2-5/16	1-1/2	5-3/16	37.0	76.0
18	H200M18	M	15.68	14.397	C1	5-1/2	6-3/4	6-3/4	9	2-23/32	2-23/32	2-5/16	1-1/2	5-3/16	37.0	82.0
19	H200M19	M	16.48	15.190	C1	5-1/2	6-3/4	6-3/4	9	2-23/32	2-23/32	2-5/16	1-1/2	5-3/16	37.0	88.0
20	H200M20	M	17.29	15.980	C1	5-1/2	6-3/4	6-3/4	9	2-23/32	2-23/32	2-5/16	1-1/2	5-3/16	37.0	97.0
21	H200M21	M	18.09	16.775	C1	5-1/2	6-3/4	6-3/4	9	2-23/32	2-23/32	2-5/16	1-1/2	5-3/16	37.0	103.0
22	H200M22	M	18.89	17.567	C1	5-1/2	6-3/4	6-3/4	9	2-23/32	2-23/32	2-5/16	1-1/2	5-3/16	37.0	112.0
23	H200M23	M	19.69	18.360	C1	5-1/2	6-3/4	6-3/4	9	2-23/32	2-23/32	2-5/16	1-1/2	5-3/16	37.0	120.0
24	H200M24	M	20.49	19.153	C1	5-1/2	6-3/4	6-3/4	9	2-23/32	2-23/32	2-5/16	1-1/2	5-3/16	37.0	131.0
25	H200M25	M	21.29	19.947	C1	5-1/2	6-3/4	6-3/4	9	2-23/32	2-23/32	2-5/16	1-1/2	5-3/16	37.0	138.0
26	H200M26	M	22.09	20.740	C1	5-1/2	6-3/4	6-3/4	9	2-23/32	2-23/32	2-5/16	1-1/2	5-3/16	37.0	148.0
28	H200M28	M	23.69	22.330	C1	5-1/2	6-3/4	6-3/4	9	2-23/32	2-23/32	2-5/16	1-1/2	5-3/16	37.0	168.0
30	H200M30	M	25.29	23.917	C1	5-1/2	6-3/4	6-3/4	9	2-23/32	2-23/32	2-5/16	1-1/2	5-3/16	37.0	190.0
32	200M32	M	26.88	25.505	C1	5-1/2	6-3/4	6-3/4	9	2-23/32	2-23/32	2-5/16	1-1/2	5-3/16	37.0	214.0
35	200M35	M	29.28	27.890	C1	5-1/2	6-3/4	6-3/4	9	2-23/32	2-23/32	2-5/16	1-1/2	5-3/16	37.0	228.0
40	200M40	M	33.27	31.865	C1	5-1/2	6-3/4	6-3/4	9	2-23/32	2-23/32	2-5/16	1-1/2	5-3/16	37.0	278.0
45	200N45	N	37.25	35.840	C1	5-7/8	8-1/8	8-1/8	10	3-13/32	3-13/32	3-3/16	1-11/16	6-1/4	57.0	348.0
54	200N45	N	44.42	42.995	C1	5-7/8	8-1/8	8-1/8	10	3-13/32	3-13/32	3-3/16	1-11/16	6-1/4	57.0	478.0
60	200N60	N	49.20	47.768	C1	5-7/8	8-1/8	8-1/8	10	3-13/32	3-13/32	3-3/16	1-11/16	6-1/4	57.0	608.0

NOTE: Maximum bores shown will accommodate a standard keyseat and a setscrew over the keyseat. Slightly larger bores are possible with no keyseat, a shallow keyseat, or a setscrew at an angle to the keyseat.