

Double Pitch Sprockets

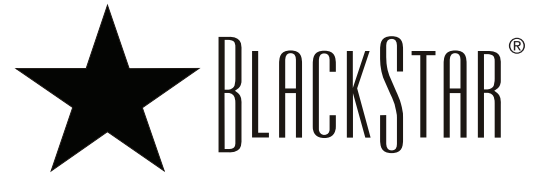

Conveyor or Driver Series— 1" Double Pitch

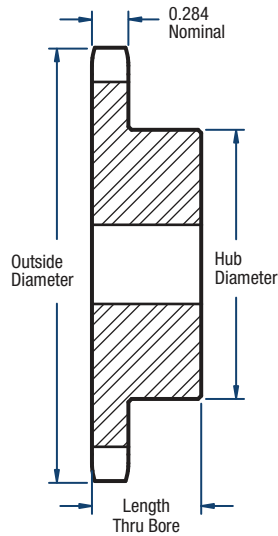

TYPE B

Conveyor or Drive Series- Standrad Roller Double Pitch- 2040/C2040

No. of Teeth	Eff. No. Teeth	Diameters (in)		Catalog Number	Type	Bore (in)		Hub (in)		Approx. Weight (lbs)
		Outside	Pitch			Minimum	Maximum	Diameter	Length Through Bore	
11	5.5	2.00	1.852	2040B11	B	1/2	13/16	1-3/8*	7/8	0.3
12	6	2.17	2.000	2040B12	B	1/2	13/16	1-9/16*	7/8	0.4
13	6.5	2.33	2.152	2040B13	B	1/2	21/32	1-9/16*	7/8	0.5
14	7	2.49	2.305	2040B14	B	1/2	1-1/32	1-11/16*	7/8	0.6
15	7.5	2.65	2.458	2040B15	B	5/8	1-7/32	1-23/32	7/8	0.7
16	8	2.81	2.613	2040B16	B	5/8	1-9/32	1-7/8	7/8	0.8
17	8.5	2.98	2.768	2040B17	B	5/8	1-5/16	2-3/64	1	1.0
18	9	3.14	2.924	2040B18	B	5/8	1-15/32	2-7/32	1	1.2
19	9.5	3.30	3.080	2040B19	B	5/8	1-5/8	2-3/8	1	1.4
20	10	3.46	3.236	2040B20	B	5/8	1-3/4	2-35/64	1	1.5
21	10.5	3.62	3.392	2040B21	B	5/8	1-25/32	2-45/64	1	1.7
22	11	3.78	3.549	2040B22	B	5/8	1-7/8	2-7/8	1	1.9
23	11.5	3.94	3.706	2040B23	B	5/8	2	3	1	2.2
24	12	4.10	3.864	2040B24	B	5/8	2-1/4	3-1/4	1	2.4
25	12.5	4.26	4.021	2040B25	B	5/8	2-1/4	3-1/4	1	2.5
26	13	4.42	4.179	2040B26	B	5/8	2-1/4	3-1/4	1	2.6
28	14	4.74	4.494	2040B28	B	5/8	2-1/4	3-1/4	1	2.7
30	15	5.06	4.810	2040B30	B	5/8	2-1/4	3-1/4	1	2.9

*Has recessed groove in hub for chain clearance.

NOTE: Maximum bores shown will accommodate a standard keyseat and a setscrew over the keyseat. Slightly larger bores are possible with no keyseat, a shallow keyseat, or a setscrew at an angle to the keyseat.