

240 Sprockets

3" Pitch

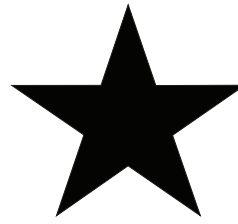

BLACKSTAR[®]

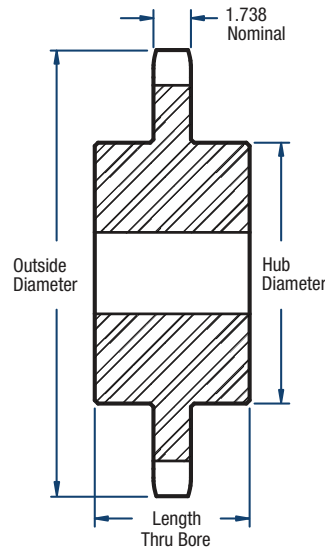

TYPE C

Single- Type C

No. of Teeth	Catalog Number	Diameters (in)		Bore (in)		Hub (in)		Approx. Weight (lbs)
		Outside	Pitch	Minimum	Maximum	Diameter	Length Through Bore	
30	H240C30	30.34	28.700	1-1/2	6	9	6-1/4	398.0
35	240C35	35.13	33.467	1-1/2	6	9	6-1/4	527.0
40	240C40	39.92	38.237	1-1/2	7	10	6-3/4	672.0
45	240C45	44.70	43.007	1-1/2	7	10	6-3/4	850.0
54	240C54	53.31	51.595	1-1/2	7	10	6-3/4	1148.0
60	240C60	59.04	57.322	1-1/2	7	10	6-3/4	1419.0

NOTE: Maximum bores shown will accommodate a standard keyseat and a setscrew over the keyseat. Slightly larger bores are possible with no keyseat, a shallow keyseat, or a setscrew at an angle to the keyseat.