

# 25 Sprockets

## 1/4" Pitch

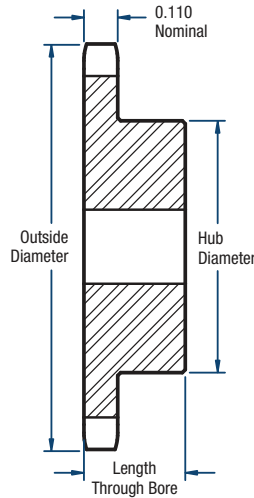

# BLACKSTAR®



**TYPE B**

### Single- Type B

No. of Teeth	Catalog Number	Diameters (in)		Bore (in)		Hub (in)		Approx. Weight (lbs)
		Outside	Pitch	Min.	Max.	Diameter	Length Through Bore	
9	H25B9	0.84	0.731	1/4	1/4	7/16	1/2	0.03
10	H25B10	0.92	0.809	1/4	1/4	1/2	1/2	0.03
11	H25B11	1.00	0.887	1/4	5/16	9/16	1/2	0.04
12	H25B12	1.08	0.966	1/4	3/8	5/8	1/2	0.06
13	H25B13	1.17	1.045	1/4	7/16	23/32	1/2	0.07
14	H25B14	1.25	1.124	1/4	9/16	13/16	1/2	0.08
15	H25B15	1.33	1.203	1/4	9/16	57/64	1/2	0.10
16	H25B16	1.41	1.282	1/4	9/16	31/32	1/2	0.12
17	H25B17	1.49	1.361	1/4	5/8	1-1/32	1/2	0.14
18	H25B18	1.57	1.440	1/4	3/4	1-1/8	1/2	0.16
19	H25B19	1.65	1.519	1/4	13/16	1-7/32	1/2	0.19
20	H25B20	1.73	1.598	1/4	7/8	1-9/32	5/8	0.25
21	H25B21	1.81	1.678	1/4	7/8	1-3/8	5/8	0.28
22	H25B22	1.89	1.757	1/4	15/16	1-7/16	5/8	0.31
23	H25B23	1.97	1.836	1/4	1	1-1/2	5/8	0.32
24	H25B24	2.05	1.915	3/8	1	1-1/2	5/8	0.33
25	H25B25	2.13	1.995	3/8	1	1-1/2	5/8	0.34
26	H25B26	2.21	2.074	3/8	1	1-1/2	5/8	0.35
28	H25B28	2.37	2.233	3/8	1	1-1/2	5/8	0.36
30	H25B30	2.53	2.392	3/8	1	1-1/2	5/8	0.38
32	25B32	2.69	2.551	3/8	1	1-1/2	5/8	0.40
35	25B35	2.93	2.789	3/8	1	1-1/2	5/8	0.46
36	25B36	3.01	2.869	3/8	1	1-1/2	3/4	0.50
40	25B40	3.33	3.187	1/2	1-3/8	2	3/4	0.53
45	25B45	3.73	3.584	1/2	1-3/8	2	3/4	0.56
48	25B48	3.97	3.823	1/2	1-3/8	2	3/4	0.56
54	25B54	4.44	4.300	1/2	1-3/8	2	3/4	1.00
60	25B60	4.92	4.777	1/2	1/38	2	3/4	1.10
70	25B70	5.72	5.572	1/2	1-3/8	2	3/4	1.25
72	25B72	5.88	5.732	1/2	1-3/8	2	3/4	1.30

Sprockets with "H" prefix have hardened teeth.

**NOTE:** Maximum bores shown will accommodate a standard keyseat and a setscrew over the keyseat. Slightly larger bores are possible with no keyseat, a shallow keyseat, or a setscrew at an angle to the keyseat.