

35 Sprockets

3/8" Pitch

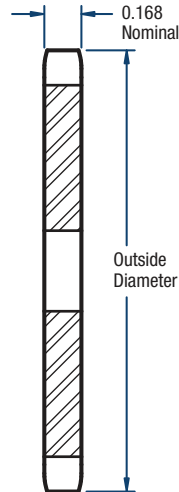

BLACKSTAR®



TYPE A

Single- Type A

No. of Teeth	Catalog Number	Diameters (in)		Stock Bore (in)	Approx. Weight (lbs)
		Outside	Pitch		
15	H35A15	1.99	1.804	1/2	0.10
16	H35A16	2.11	1.922	1/2	0.12
17	H35A17	2.23	2.041	1/2	0.12
18	H35A18	2.35	2.160	1/2	0.14
19	H35A19	2.47	2.279	1/2	0.16
20	H35A20	2.59	2.397	1/2	0.20
21	H35A21	2.71	2.516	1/2	0.20
22	H35A22	2.83	2.635	1/2	0.22
23	H35A23	2.95	2.754	1/2	0.24
24	H35A24	3.07	2.873	1/2	0.26
25	H35A25	3.19	2.992	1/2	0.28
26	H35A26	3.31	3.111	1/2	0.28
27	H35A27	3.43	3.230	1/2	0.34
28	H35A28	3.55	3.349	1/2	0.34
30	H35A30	3.79	3.588	1/2	0.46
32	35A32	4.03	3.826	5/8	0.46
35	35A35	4.39	4.184	5/8	0.60
36	35A36	4.51	4.303	5/8	0.62
40	35A40	4.99	4.780	19/32	0.70
42	35A42	5.23	5.018	19/32	0.78
45	35A45	5.59	5.376	19/32	0.88
48	35A48	5.95	5.734	19/32	1.21
54	35A54	6.66	6.449	19/32	1.32
60	35A60	7.38	7.165	23/32	1.66
70	35A70	8.58	8.358	23/32	2.30
72	35A72	8.81	8.597	23/32	2.56
80	35A80	9.77	9.552	23/32	3.16
84	35A84	10.25	10.029	23/32	3.26
96	35A96	11.68	11.461	23/32	4.64
112	35A112	13.59	13.371	23/32	5.05

Sprockets with "H" prefix have hardened teeth.

NOTE: Maximum bores shown will accommodate a standard keyseat and a setscrew over the keyseat. Slightly larger bores are possible with no keyseat, a shallow keyseat, or a setscrew at an angle to the keyseat.