

35 Sprockets

3/8" Pitch

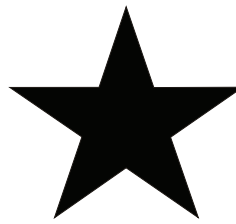

BLACKSTAR®

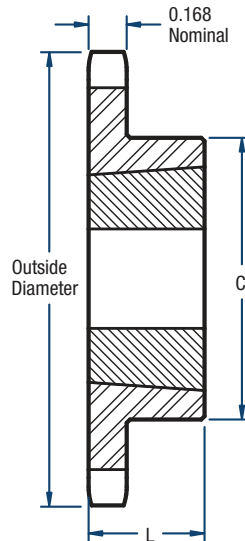

TYPE B

Single- TL Style

No. of Teeth	Catalog Number	Bushing	Diameters (in)		Type	Max. Bore	Dimensions (in)		Approx. Weight (lbs)	
			Outside Dia.	Pitch Dia.			L	C	Bushing Only	Sprocket Only
18	H35BTL18	1008	2.35	2.160	B	1	7/8	1-7/8*	0.3	0.4
19	H35BTL19	1008	2.47	2.279	B	1	7/8	1-13/16	0.3	0.5
20	H35BTL20	1008	2.59	2.397	B	1	7/8	1-15/16	0.3	0.6
21	H35BTL21	1008	2.71	2.516	B	1	7/8	2-1/16	0.3	0.7
22	H35BTL22	1210	2.83	2.635	B	1-1/4	1	2-3/8*	0.6	0.8
23	H35BTL23	1210	2.95	2.754	B	1-1/4	1	2-7/16	0.6	0.9
24	H35BTL24	1210	3.07	2.873	B	1-1/4	1	2-7/16	0.6	0.9
25	H35BTL25	1210	3.19	2.992	B	1-1/4	1	2-7/16	0.6	1.2
26	H35BTL26	1610	3.31	3.111	B	1-5/8	1	2-7/8*	0.9	1.1
28	H35BTL28	1610	3.55	3.349	B	1-5/8	1	2-7/8	0.9	1.2
30	H35BTL30	1610	3.79	3.588	B	1-5/8	1	3-1/8	0.9	1.2
32	35BTL32	1610	4.03	3.826	B	1-5/8	1	3-1/4	0.9	1.3
35	35BTL35	1610	4.39	4.184	B	1-5/8	1	3-1/4	0.9	1.4
36	35BTL36	1610	4.51	4.303	B	1-5/8	1	3-1/4	0.9	1.4
40	35BTL40	1610	4.99	4.780	B	1-5/8	1	3-1/4	0.9	1.9
42	35BTL42	1610	5.23	5.018	B	1-5/8	1	3-1/4	0.9	2.0
45	35BTL45	1610	5.59	5.376	B	1-5/8	1	3-1/4	0.9	2.1
48	35BTL48	1610	5.95	5.734	B	1-5/8	1	3-1/4	0.9	2.3
54	35BTL54	1610	6.66	6.449	B	1-5/8	1	3-1/4	0.9	2.6
60	35BTL60	1610	7.38	7.165	B	1-5/8	1	3-1/4	0.9	3.0
70	35BTL70	1610	8.58	8.358	B	1-5/8	1	3-1/4	0.9	3.7
72	35BTL72	1610	8.81	8.597	B	1-5/8	1	3-1/4	0.9	3.9
80	35BTL80	1610	9.77	9.552	B	1-5/8	1	3-1/4	0.9	4.5
84	35BTL84	1610	10.25	10.029	B	1-5/8	1	3-1/4	0.9	4.9
96	35BTL96	1610	11.68	11.461	B	1-5/8	1	3-1/4	0.9	6.0
112	35BTL112	1610	13.59	13.371	B	1-5/8	1	3-1/4	0.9	7.8

*Has recessed groove in the hub for chain clearance.

Sprockets with "H" prefix have hardened teeth.

NOTE: Maximum bores shown will accommodate a standard keyseat and a setscrew over the keyseat. Slightly larger bores are possible with no keyseat, a shallow keyseat, or a setscrew at an angle to the keyseat.