

35 Sprockets

3/8" Pitch

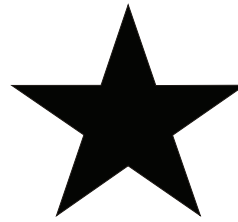

BLACKSTAR®

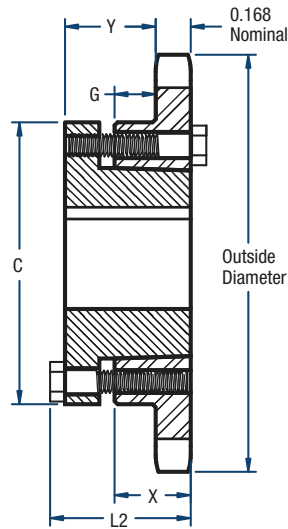

TYPE B

Single- QD Style

No. of Teeth	Catalog Number	Bushing	Diameters (in)		Type	Max. Bore	Dimensions (in)					Approx. Weight (lbs)	
			Outside Dia.	Pitch Dia.			L2	C	Y	G	X	Bushing Only	Sprocket Only
19	H35JA19	JA	2.47	2.279	B	1-1/4	1-1/8	2-1/16	53/64	29/64	5/8	0.8	0.3
20	H35JA20	JA	2.59	2.397	B	1-1/4	1-1/8	2-1/16	53/64	29/64	5/8	0.8	0.3
21	H35JA21	JA	2.71	2.516	B	1-1/4	1-1/8	2-1/16	53/64	29/64	5/8	0.8	0.3
22	H35JA22	JA	2.83	2.635	B	1-1/4	1-1/8	2-1/16	53/64	29/64	5/8	0.8	0.4
23	H35JA23	JA	2.95	2.754	B	1-1/4	1-1/8	2-1/16	53/64	29/64	5/8	0.8	0.4
24	H35JA24	JA	3.07	2.873	B	1-1/4	1-1/8	2-1/16	53/64	29/64	5/8	0.8	0.4
25	H35JA25	JA	3.19	2.992	B	1-1/4	1-1/8	2-1/16	53/64	29/64	5/8	0.8	0.4
26	H35JA26	JA	3.31	3.111	B	1-1/4	1-1/8	2-1/16	53/64	29/64	5/8	0.8	0.5
27	H35JA27	JA	3.43	3.230	B	1-1/4	1-1/8	2-1/16	53/64	29/64	5/8	0.8	0.5
28	H35JA28	JA	3.55	3.349	B	1-1/4	1-1/8	2-1/16	53/64	29/64	5/8	0.8	0.5
30	H35JA30	JA	3.79	3.588	B	1-1/4	1-1/8	2-1/16	53/64	29/64	5/8	0.8	0.6
32	35JA32	JA	4.03	3.826	B	1-1/4	1-1/8	2-1/16	53/64	29/64	5/8	0.8	0.8
35	35JA35	JA	4.39	4.184	B	1-1/4	1-1/8	2-1/16	53/64	29/64	5/8	0.8	1.0
36	35SH36	SH	4.51	4.303	B	1-5/8	1-7/16	2-11/16	1-5/64	41/64	13/16	1.0	1.1
40	35SH40	SH	4.99	4.780	B	1-5/8	1-7/16	2-11/16	1-5/64	41/64	13/16	1.0	1.2
42	35SH42	SH	5.23	5.018	B	1-5/8	1-7/16	2-11/16	1-5/64	41/64	13/16	1.0	1.3
45	35SH45	SH	5.59	5.376	B	1-5/8	1-7/16	2-11/16	1-5/64	41/64	13/16	1.0	1.4
48	35SH48	SH	5.95	5.734	B	1-5/8	1-7/16	2-11/16	1-5/64	41/64	13/16	1.0	1.6
54	35SH54	SH	6.66	6.449	B	1-5/8	1-7/16	2-11/16	1-5/64	41/64	13/16	1.0	1.9
60	35SH60	SH	7.38	7.165	B	1-5/8	1-7/16	2-11/16	1-5/64	41/64	13/16	1.0	2.3
70	35SH70	SH	8.58	8.358	B	1-5/8	1-7/16	2-11/16	1-5/64	41/64	13/16	1.0	2.9
72	35SH72	SH	8.81	8.597	B	1-5/8	1-7/16	2-11/16	1-5/64	41/64	13/16	1.0	3.1
80	35SH80	SH	9.77	9.552	B	1-5/8	1-7/16	2-11/16	1-5/64	41/64	13/16	1.0	3.7
84	35SH84	SH	10.25	10.029	B	1-5/8	1-7/16	2-11/16	1-5/64	41/64	13/16	1.0	4.0
96	35SH96	SH	11.68	11.461	B	1-5/8	1-7/16	2-11/16	1-5/64	41/64	13/16	1.0	5.4
112	35SH112	SH	13.59	13.371	B	1-5/8	1-7/16	2-11/16	1-5/64	41/64	13/16	1.0	6.6

Sprockets with "H" prefix have hardened teeth.

NOTE: Maximum bores shown will accommodate a standard keyseat and a setscrew over the keyseat. Slightly larger bores are possible with no keyseat, a shallow keyseat, or a setscrew at an angle to the keyseat.