

40 Sprockets

1/2" Pitch

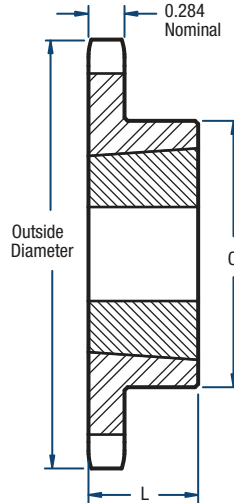

BLACKSTAR®



TYPE B

Single- TL Style

No. of Teeth	Catalog Number	Bushing	Diameters (in)		Type	Max. Bore	Dimensions (in)		Approx. Weight (lbs)	
			Outside Diameter	Pitch Diameter			L	C	Bushing Only	Sprocket Only
14	H40BTL14	1008	2.49	2.247	B	1	7/8	1-13/16*	0.3	0.3
15	H40BTL15	1008	2.65	2.405	B	1	7/8	1-13/16	0.3	0.4
16	H40BTL16	1008	2.81	2.563	B	1	7/8	1-15/16	0.3	0.5
17	H40BTL17	1210	2.98	2.721	B	1-1/4	1	2-3/8*	0.3	0.5
18	H40BTL18	1210	3.14	2.879	B	1-1/4	1	2-15/32*	0.6	0.6
19	H40BTL19	1210	3.30	3.038	B	1-1/4	1	2-15/32	0.6	0.7
20	H40BTL20	1610	3.46	3.196	B	1-5/8	1	2-25/32*	0.9	0.7
21	H40BTL21	1610	3.62	3.355	B	1-5/8	1	2-25/32	0.9	0.8
22	H40BTL22	1610	3.78	3.513	B	1-5/8	1	2-25/32	0.9	0.9
23	H40BTL23	1610	3.94	3.672	B	1-5/8	1	3	0.9	1.0
24	H40BTL24	1610	4.10	3.831	B	1-5/8	1	3-1/4	0.9	1.4
25	H40BTL25	1610	4.26	3.989	B	1-5/8	1	3-1/4	0.9	1.5
26	H40BTL26	1610	4.42	4.148	B	1-5/8	1	3-1/4	0.9	1.7
28	H40BTL28	1610	4.74	4.466	B	1-5/8	1	3	0.9	1.8
30	H40BTL30	1610	5.06	4.783	B	1-5/8	1	3	0.9	1.9
32	40BTL32	1610	5.38	5.101	B	1-5/8	1	3	0.9	1.9
35	40BTL35	1610	5.86	5.578	B	1-5/8	1	3	0.9	2.3
36	40BTL36	1610	6.02	5.737	B	1-5/8	1	3	0.9	2.4
40	40BTL40	1610	6.65	6.373	B	1-5/8	1	3	0.9	2.8
42	40BTL42	1610	6.97	6.691	B	1-5/8	1	3	0.9	2.9
45	40BTL45	1610	7.45	7.168	B	1-5/8	1	3	0.9	3.5
48	40BTL48	1610	7.93	7.645	B	1-5/8	1	3	0.9	4.0
54	40BTL54	1610	8.89	8.599	B	1-5/8	1	3	0.9	4.9
60	40BTL60	1610	9.84	9.554	B	1-5/8	1	3	0.9	6.0
70	40BTL70	2012	11.43	11.145	B	2	1-1/4	3-9/16	1.7	8.2
72	40BTL72	2012	11.75	11.463	B	2	1-1/4	3-9/16	1.7	9.0
80	40BTL80	2012	13.03	12.736	B	2	1-1/4	3-9/16	1.7	10.8
84	40BTL84	2012	13.66	13.372	B	2	1-1/4	3-9/16	1.7	11.3
96	40BTL96	2012	15.57	15.282	B	2	1-1/4	3-9/16	1.7	14.6
112	40BTL112	2517	18.12	17.827	B	2-1/2	1-3/4	4-1/4	1.7	20.5

*Has a recessed groove in the hub for chain clearance.
Sprockets with "H" prefix have hardened teeth.

NOTE: Maximum bores shown will accommodate a standard keyseat and a setscrew over the keyseat. Slightly larger bores are possible with no keyseat, a shallow keyseat, or a setscrew at an angle to the keyseat.