

40 Sprockets

1/2" Pitch

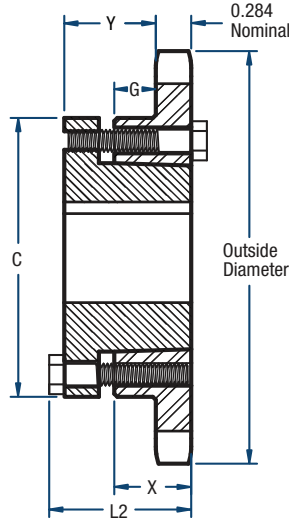

BLACKSTAR®



TYPE B

Single- QD Style

No. of Teeth	Catalog Number	Bushing	Diameters (in)		Type	Max. Bore	Dimensions (in)					Approx. Weight (lbs)	
			Outside Diameter	Pitch Diameter			L2	C	Y	G	X	Bushing Only	Sprocket Only
15	H40JA15	JA	2.65	2.405	B	1 1/4	1 1/8	2 1/16	23/32	11/32	5/8	0.9	0.34
16	H40JA16	JA	2.81	2.563	B	1 1/4	1 1/8	2 1/16	23/32	11/32	5/8	0.9	0.40
17	H40JA17	JA	2.98	2.721	B	1 1/4	1 1/8	2 1/16	23/32	11/32	5/8	0.9	0.48
18	H40JA18	JA	3.14	2.879	B	1 1/4	1 1/8	2 1/16	23/32	11/32	5/8	0.9	0.54
19	H40JA19	JA	3.30	3.038	B	1 1/4	1 1/8	2 1/16	23/32	11/32	5/8	0.9	0.60
20	H40SH20	SH	3.46	3.196	B	1 5/8	1 7/16	2 11/16	31/32	17/32	13/16	1.0	0.76
21	H40SH21	SH	3.62	3.355	B	1 5/8	1 7/16	2 11/16	31/32	17/32	13/16	1.0	0.84
22	H40SH22	SH	3.78	3.513	B	1 5/8	1 7/16	2 11/16	31/32	17/32	13/16	1.0	0.92
23	H40SH23	SH	3.94	3.672	B	1 5/8	1 7/16	2 11/16	31/32	17/32	13/16	1.0	1.14
24	H40SH24	SH	4.10	3.831	B	1 5/8	1 7/16	2 11/16	31/32	17/32	13/16	1.0	1.22
25	H40SH25	SH	4.26	3.989	B	1 5/8	1 7/16	2 11/16	31/32	17/32	13/16	1.0	1.30
26	H40SH26	SH	4.42	4.148	B	1 5/8	1 7/16	2 11/16	31/32	17/32	13/16	1.0	1.44
27	H40SH27	SH	4.58	4.307	B	1 5/8	1 7/16	2 11/16	31/32	17/32	13/16	1.0	1.46
28	H40SH28	SH	4.74	4.465	B	1 5/8	1 7/16	2 11/16	31/32	17/32	13/16	1.0	1.54
30	H40SH30	SH	5.06	4.783	B	1 5/8	1 7/16	2 11/16	31/32	17/32	13/16	1.0	1.72
32	40SH32	SH	5.38	5.101	B	1 5/8	1 7/16	2 11/16	31/32	17/32	13/16	1.0	1.90
35	40SH35	SH	5.86	5.578	B	1 5/8	1 7/16	3	31/32	17/32	13/16	1.0	2.22
36	40SDS36	SDS	6.02	5.737	B	2	1 1/2	3 3/16	1 1/32	15/32	3/4	1.5	2.20
40	40SDS40	SDS	6.65	6.373	B	2	1 1/2	3 3/16	1 1/32	15/32	3/4	1.5	2.72
42	40SDS42	SDS	6.97	6.691	B	2	1 1/2	3 3/16	1 1/32	15/32	3/4	1.5	2.92
45	40SDS45	SDS	7.45	7.168	B	2	1 1/2	3 3/16	1 1/32	15/32	3/4	1.5	3.32
48	40SDS48	SDS	7.93	7.645	B	2	1 1/2	3 3/16	1 1/32	15/32	3/4	1.5	3.70
54	40SDS54	SDS	8.89	8.599	B	2	1 1/2	3 3/16	1 1/32	15/32	3/4	1.5	4.78
60	40SDS60	SDS	9.84	9.554	B	2	1 1/2	3 3/16	1 1/32	15/32	3/4	1.5	5.86
70	40SK70	SK	11.43	11.145	B	2 5/8	2 1/8	3 7/8	1 19/32	31/32	1 1/4	2.0	8.68
72	40SK72	SK	11.75	11.463	B	2 5/8	2 1/8	3 7/8	1 19/32	31/32	1 1/4	2.0	8.84
80	40SK80	SK	13.03	12.736	B	2 5/8	2 1/8	3 7/8	1 19/32	31/32	1 1/4	2.0	11.20
84	40SK84	SK	13.66	13.372	B	2 5/8	2 1/8	3 7/8	1 19/32	31/32	1 1/4	2.0	11.56
96	40SK96	SK	15.57	15.282	B	2 5/8	2 1/8	3 7/8	1 19/32	31/32	1 1/4	2.0	15.76
112	40SK112	SK	18.12	17.827	B	2 5/8	2 1/8	3 7/8	1 19/32	31/32	1 1/4	2.0	20.28

Sprockets with "H" prefix have hardened teeth.

NOTE: Maximum bores shown will accommodate a standard keyseat and a setscrew over the keyseat. Slightly larger bores are possible with no keyseat, a shallow keyseat, or a setscrew at an angle to the keyseat.