

# 41 Sprockets

## 1/2" Pitch

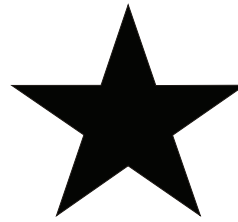

# BLACKSTAR®

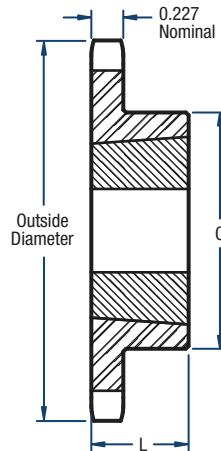

TL - TYPE B

### Single- TL Style

No. of Teeth	Catalog Number	Bushing	Diameters (in)		Type	Max. Bore	Dimensions (in)		Approx. Weight (lbs)	
			Outside	Pitch			L	C	Bushing Only	Sprocket Only
14	H41BTL14	1008	2.49	2.247	B	1	7/8	1-7/8*	0.3	0.4
15	H41BTL15	1008	2.65	2.405	B	1	7/8	1-7/8	0.3	0.5
16	H41BTL16	1008	2.81	2.563	B	1	7/8	2	0.3	0.6
17	H41BTL17	1210	2.98	2.721	B	1-1/4	1	2-3/8*	0.6	0.7
18	H41BTL18	1210	3.14	2.879	B	1-1/4	1	2-3/8	0.6	0.9
19	H41BTL19	1210	3.30	3.038	B	1-1/4	1	2-1/2	0.6	1.1
20	H41BTL20	1610	3.46	3.196	B	1-5/8	1	2-7/8*	0.9	1.1
21	H41BTL21	1610	3.62	3.355	B	1-5/8	1	3	0.9	1.2
22	H41BTL22	1610	3.78	3.513	B	1-5/8	1	3	0.9	1.3
23	H41BTL23	1610	3.94	3.672	B	1-5/8	1	3	0.9	1.4
24	H41BTL24	1610	4.10	3.831	B	1-5/8	1	3-1/4	0.9	1.4
25	H41BTL25	1610	4.26	3.989	B	1-5/8	1	3-1/4	0.9	1.5
26	H41BTL26	1610	4.42	4.148	B	1-5/8	1	3-1/4	0.9	1.5
28	H41BTL28	1610	4.74	4.465	B	1-5/8	1	3-1/4	0.9	1.7
30	H41BTL30	1610	5.06	4.783	B	1-5/8	1	3-1/4	0.9	1.8
32	41BTL32	1610	5.38	5.101	B	1-5/8	1	3-1/4	0.9	1.9
35	41BTL35	1610	5.86	5.578	B	1-5/8	1	3-1/4	0.9	2.3
36	41BTL36	1610	6.02	5.737	B	1-5/8	1	3-1/4	0.9	2.4
40	41BTL40	1610	6.65	6.373	B	1-5/8	1	3-1/4	0.9	2.7
45	41BTL45	1610	7.45	7.168	B	1-5/8	1	3-1/4	0.9	3.5
48	41BTL48	1610	7.93	7.645	B	1-5/8	1	3-1/4	0.9	4.1
54	41BTL54	1610	8.89	8.599	B	1-5/8	1	3-1/4	0.9	4.9
60	41BTL60	1610	9.84	9.554	B	1-5/8	1	3-1/4	0.9	5.7
70	41BTL70	1610	11.43	11.145	B	1-5/8	1	3-1/4	0.9	7.4
72	41BTL72	1610	11.75	11.463	B	1-5/8	1	3-1/4	0.9	8.2
80	41BTL80	1610	13.03	12.736	B	1-5/8	1	3-1/4	0.9	9.6
96	41BTL96	1610	15.57	15.282	B	1-5/8	1	3-1/4	0.9	13.1

\*Has recessed groove in the hub for chain clearance.  
Sprockets with "H" prefix have hardened teeth.

**NOTE:** Maximum bores shown will accommodate a standard keyseat and a setscrew over the keyseat. Slightly larger bores are possible with no keyseat, a shallow keyseat, or a setscrew at an angle to the keyseat.