

41 Sprockets

1/2" Pitch

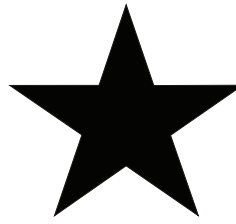

BLACKSTAR®

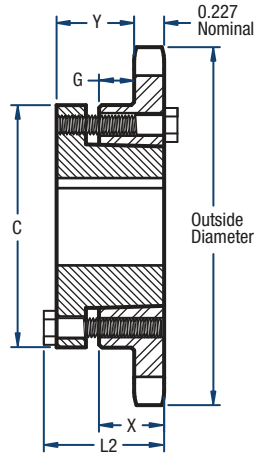

QD - TYPE B

Single- QD Style

No. of Teeth	Catalog Number	Bushing	Diameters (in)		Type	Max. Bore	Dimensions (in)					Approx. Weight (lbs)	
			Outside	Pitch			L2	C	Y	G	X	Bushing Only	Sprocket Only
15	H41JA15	JA	2.65	2.405	B	1-1/4	1-1/8	2-1/16	49/64	25/64	5/8	0.9	0.3
16	H41JA16	JA	2.81	2.563	B	1-1/4	1-1/8	2-1/16	49/64	25/64	5/8	0.9	0.4
17	H41JA17	JA	2.98	2.721	B	1-1/4	1-1/8	2-1/16	49/64	25/64	5/8	0.9	0.5
18	H41JA18	JA	3.14	2.879	B	1-1/4	1-1/8	2-1/16	49/64	25/64	5/8	0.9	0.6
19	H41JA19	JA	3.30	3.038	B	1-1/4	1-1/8	2-1/16	49/64	25/64	5/8	0.9	0.7
20	H41SH20	SH	3.46	3.196	B	1-5/8	1-7/16	2-11/16	1-1/32	37/64	13/16	1.0	0.8
21	H41SH21	SH	3.62	3.355	B	1-5/8	1-7/16	2-11/16	1-1/32	37/64	13/16	1.0	0.8
22	H41SH22	SH	3.78	3.513	B	1-5/8	1-7/16	2-11/16	1-1/32	37/64	13/16	1.0	1.1
23	H41SH23	SH	3.94	3.672	B	1-5/8	1-7/16	2-11/16	1-1/32	37/64	13/16	1.0	1.1
24	H41SH24	SH	4.10	3.831	B	1-5/8	1-7/16	2-11/16	1-1/32	37/64	13/16	1.0	1.2
25	H41SH25	SH	4.26	3.989	B	1-5/8	1-7/16	2-11/16	1-1/32	37/64	13/16	1.0	1.2
26	H41SH26	SH	4.42	4.148	B	1-5/8	1-7/16	2-11/16	1-1/32	37/64	13/16	1.0	1.3
27	H41SH27	SH	4.58	4.307	B	1-5/8	1-7/16	2-11/16	1-1/32	37/64	13/16	1.0	1.4
28	H41SH28	SH	4.74	4.465	B	1-5/8	1-7/16	2-11/16	1-1/32	37/64	13/16	1.0	1.5
30	H41SH30	SH	5.06	4.783	B	1-5/8	1-7/16	2-11/16	1-1/32	37/64	13/16	1.0	1.6
32	41SH32	SH	5.38	5.101	B	1-5/8	1-7/16	2-11/16	1-1/32	37/64	13/16	1.0	1.7
35	41SH35	SH	5.86	5.578	B	1-5/8	1-7/16	2-11/16	1-1/32	37/64	13/16	1.0	2.5
36	41SDS36	SDS	6.02	5.737	B	2	1-1/2	3-3/16	1-3/32	17/32	3/4	1.0	1.9
40	41SDS40	SDS	6.65	6.373	B	2	1-1/2	3-3/16	1-3/32	17/32	3/4	1.0	2.3
42	41SDS42	SDS	6.97	6.691	B	2	1-1/2	3-3/16	1-3/32	17/32	3/4	1.0	2.4
45	41SDS45	SDS	7.45	7.168	B	2	1-1/2	3-3/16	1-3/32	17/32	3/4	1.0	2.8
48	41SDS48	SDS	7.93	7.645	B	2	1-1/2	3-3/16	1-3/32	17/32	3/4	1.0	3.4
54	41SDS54	SDS	8.89	8.599	B	2	1-1/2	3-3/16	1-3/32	17/32	3/4	1.0	4.0
60	41SDS60	SDS	9.84	9.554	B	2	1-1/2	3-3/16	1-3/32	17/32	3/4	1.0	5.5
70	41SK70	SK	11.43	11.145	B	2-5/8	2-1/8	3-7/8	1-41/64	1-1/32	1-1/4	2.0	7.4
72	41SK72	SK	11.75	11.463	B	2-5/8	2-1/8	3-7/8	1-41/64	1-1/32	1-1/4	2.0	8.0
80	41SK80	SK	13.03	12.736	B	2-5/8	2-1/8	3-7/8	1-41/64	1-1/32	1-1/4	2.0	9.6
84	41SK84	SK	13.66	13.372	B	2-5/8	2-1/8	3-7/8	1-41/64	1-1/32	1-1/4	2.0	10.4
96	41SK96	SK	15.57	15.282	B	2-5/8	2-1/8	3-7/8	1-41/64	1-1/32	1-1/4	2.0	12.8
112	41SK112	SK	18.12	17.827	B	2-5/8	2-1/8	3-7/8	1-41/64	1-1/32	1-1/4	2.0	17.3

Sprockets with "H" prefix have hardened teeth.

NOTE: Maximum bores shown will accommodate a standard keyseat and a setscrew over the keyseat. Slightly larger bores are possible with no keyseat, a shallow keyseat, or a setscrew at an angle to the keyseat.