

50 Sprockets

5/8" Pitch



BLACKSTAR®

Single- Type A

No. of Teeth	Catalog Number	Diameters (in)		Stock Bore (in)	Approx. Weight (lbs)
		Outside Diameter	Pitch Diameter		
12	H50A12	2.71	2.415	5/8	0.3
13	H50A13	2.91	2.612	5/8	0.4
14	H50A14	3.11	2.809	5/8	0.5
15	H50A15	3.32	3.006	5/8	0.5
16	H50A16	3.52	3.204	5/8	0.7
17	H50A17	3.72	3.401	5/8	0.8
18	H50A18	3.92	3.599	5/8	0.9
19	H50A19	4.12	3.798	5/8	0.9
20	H50A21	4.32	3.995	3/4	1.1
21	H50A21	4.52	4.194	3/4	1.1
22	H50A22	4.72	4.392	3/4	1.3
23	H50A23	4.92	4.590	3/4	1.4
24	H50A24	5.12	4.788	23/32	1.5
25	H50A25	5.32	4.987	23/32	1.6
26	H50A26	5.52	5.185	23/32	1.7
27	H50A27	5.72	5.384	23/32	2.0
28	H50A28	5.92	5.582	23/32	2.0
29	H50A29	6.12	5.781	23/32	2.4
30	H50A30	6.32	5.979	23/32	2.5
31	50A31	6.52	6.178	23/32	2.8
32	50A32	6.72	6.376	23/32	2.7
33	50A33	6.92	6.575	23/32	3.1
34	50A34	7.12	6.774	23/32	3.2
35	50A35	7.32	6.973	23/32	3.3
36	50A36	7.52	7.171	23/32	3.8
37	50A37	7.72	7.370	23/32	4.0
38	50A38	7.92	7.569	23/32	4.1
39	50A39	8.12	7.768	23/32	4.4
40	50A40	8.32	7.966	23/32	4.5
41	50A41	8.52	8.165	23/32	4.9
42	50A42	8.72	8.364	23/32	5.0
43	50A43	8.91	8.563	23/32	5.2
44	50A44	9.11	8.761	23/32	5.4
45	50A45	9.31	8.960	23/32	5.9
46	50A46	9.51	9.159	15/16	6.4
47	50A47	9.71	9.358	15/16	6.5
48	50A48	9.91	9.556	15/16	6.6
49	50A48	10.11	9.755	15/16	7.1
50	50A49	10.31	9.954	15/16	7.1
51	50A50	10.51	10.153	15/16	7.3
52	50A51	10.71	10.351	15/16	8.0
53	50A52	10.91	10.550	15/16	8.1
54	50A53	11.11	10.749	15/16	8.3
55	50A54	11.31	10.948	15/16	8.6
56	50A55	11.50	11.147	15/16	8.9
57	50A56	11.70	11.346	15/16	9.4
58	50A57	11.90	11.544	15/16	10.3
59	50A58	12.10	11.743	15/16	10.5
60	50A59	12.30	11.942	15/16	10.8
70	50A70	14.29	13.931	15/16	14.0
72	50A72	14.69	14.329	15/16	15.2
76	50A76	15.49	15.124	15/16	20.1
80	50A80	16.28	15.919	15/16	21.0
84	50A84	17.08	16.715	15/16	22.1
95	50A95	19.27	18.903	15/16	27.0
96	50A96	19.47	19.102	15/16	27.4
112	50A112	22.65	22.284	15/16	37.7

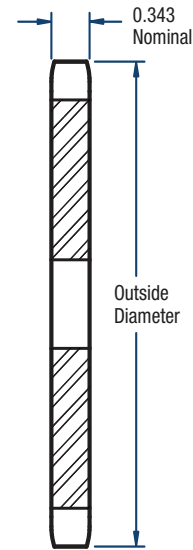

TYPE A

Sprockets with "H" prefix have hardened teeth.