

50 Sprockets

5/8" Pitch

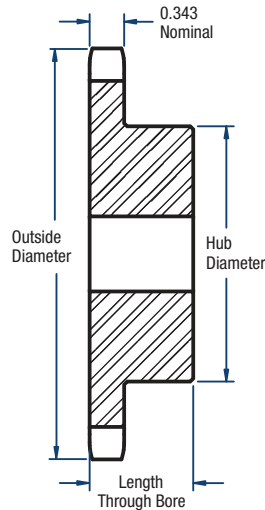

BLACKSTAR®



TYPE B

Single- Type B (continued on next page)

No. of Teeth	Catalog Number	Diameters (in)		Bore (in)		Hub (in)		Approx. Weight (lbs)
		Outside	Pitch	Min.	Max.	Diameter	Length Through Bore	
8	H50B8	1.88	1.633	5/8	5/8	1-1/8*	1	0.25
9	H50B9	2.09	1.828	5/8	3/4	1-3/8*	1	0.36
10	H50B10	2.30	2.023	5/8	7/8	1-9/16*	1	0.48
11	H50B11	2.50	2.219	5/8	1	1-3/4*	1	0.64
12	H50B12	2.71	2.415	5/8	1-1/4	1-63/64*	1	0.83
13	H50B13	2.91	2.612	5/8	1-5/16	1-7/8	1	0.88
14	H50B14	3.11	2.809	5/8	1-7/16	2-1/8	1	1.13
15	H50B15	3.32	3.006	5/8	1-1/2	2-3/8	1	1.34
16	H50B16	3.52	3.204	5/8	1-3/4	2-1/2	1	1.51
17	H50B17	3.72	3.401	5/8	1-7/8	2-11/16	1	1.74
18	H50B18	3.92	3.599	5/8	1-7/8	2-7/8	1	2.00
19	H50B19	4.12	3.798	5/8	2	3	1	2.22
20	H50B20	4.32	3.995	3/4	2	3	1	2.28
21	H50B21	4.52	4.194	3/4	2	3	1	2.40
22	H50B22	4.72	4.392	3/4	2	3	1	2.56
23	H50B23	4.92	4.590	3/4	2	3	1	2.66
24	H50B24	5.12	4.788	3/4	2	3	1-1/4	3.30
25	H50B25	5.32	4.987	3/4	2	3	1-1/4	3.40
26	H50B26	5.52	5.185	3/4	2	3	1-1/4	3.44
27	H50B27	5.72	5.384	3/4	2	3	1-1/4	3.74
28	H50B28	5.92	5.582	3/4	2	3	1-1/4	3.80
29	H50B29	6.12	5.781	3/4	2	3	1-1/4	4.06
30	H50B30	6.32	5.979	3/4	2-1/4	3-1/4	1-1/4	4.56
31	50B31	6.52	6.178	3/4	2-1/4	3-1/4	1-1/4	4.74
32	50B32	6.72	6.376	3/4	2-1/4	3-1/4	1-1/4	4.96
33	50B33	6.92	6.575	3/4	2-1/4	3-1/4	1-1/4	5.20
34	50B34	7.12	6.774	3/4	2-1/4	3-1/4	1-1/4	5.14
35	50B35	7.32	6.973	3/4	2-1/4	3-1/4	1-1/4	5.44
36	50B36	7.52	7.171	3/4	2-1/4	3-1/4	1-1/4	5.64
37	50B37	7.72	7.370	3/4	2-1/4	3-1/4	1-1/4	5.90
38	50B38	7.92	7.569	3/4	2-1/4	3-1/4	1-1/4	6.08

*Has recessed groove in the hub for chain clearance.
Sprockets with "H" prefix have hardened teeth.

NOTE: Maximum bores shown will accommodate a standard keyseat and a setscrew over the keyseat. Slightly larger bores are possible with no keyseat, a shallow keyseat, or a setscrew at an angle to the keyseat.

50 Sprockets

5/8" Pitch

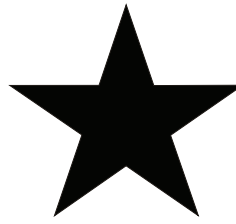

BLACKSTAR®

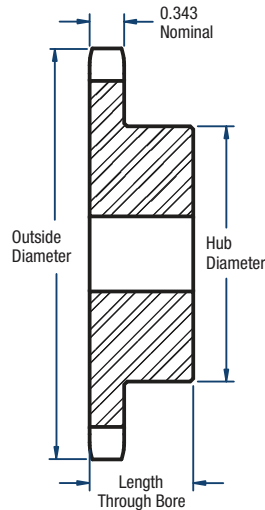

TYPE B

Single- Type B (continued)

No. of Teeth	Catalog Number	Diameters (in)		Bore (in)		Hub (in)		Approx. Weight (lbs)
		Outside	Pitch	Min.	Max.	Diameter	Length Through Bore	
38	50B38	7.92	7.569	3/4	2-1/4	3-1/4	1-1/4	6.08
39	50B39	8.12	7.768	3/4	2-1/4	3-1/4	1-1/4	6.30
40	50B40	8.32	7.966	3/4	2-1/4	3-1/4	1-1/4	6.50
41	50B41	8.52	8.165	3/4	2-1/4	3-1/4	1-1/4	6.64
42	50B42	8.72	8.364	3/4	2-1/4	3-1/4	1-1/4	6.96
43	50B43	8.91	8.563	3/4	2-1/4	3-1/4	1-1/4	7.06
44	50B44	9.11	8.761	3/4	2-1/4	3-1/4	1-1/4	7.58
45	50B45	9.31	8.960	3/4	2-1/2	3-3/4	1-1/4	8.58
46	50B46	9.51	9.159	3/4	2-1/2	3-3/4	1-1/4	8.22
47	50B47	9.71	9.358	3/4	2-1/2	3-3/4	1-1/4	8.48
48	50B48	9.91	9.556	1	2-1/2	3-3/4	1-1/4	9.28
49	50B49	10.11	9.755	1	2-1/2	3-3/4	1-1/4	9.22
50	50B50	10.31	9.954	1	2-1/2	3-3/4	1-1/4	9.88
51	50B51	10.51	10.153	1	2-1/2	3-3/4	1-1/4	9.70
52	50B52	10.71	10.351	1	2-1/2	3-3/4	1-1/4	10.24
53	50B53	10.91	10.550	1	2-1/2	3-3/4	1-1/4	10.48
54	50B54	11.11	10.749	1	2-1/2	3-3/4	1-1/4	11.00
55	50B55	11.31	10.948	1	2-1/2	3-3/4	1-1/4	10.93
56	50B56	11.50	11.147	1	2-1/2	3-3/4	1-1/4	11.50
57	50B57	11.70	11.346	1	2-1/2	3-3/4	1-1/4	12.00
58	50B58	11.90	11.544	1	2-1/2	3-3/4	1-1/4	11.82
59	50B59	12.10	11.743	1	2-1/2	3-3/4	1-1/4	12.32
60	50B60	12.30	11.942	1	2-1/2	3-3/4	1-1/4	13.00
70	50B70	14.29	13.931	1	2-1/2	3-3/4	1-3/4	18.16
72	50B72	14.69	14.329	1	2-1/2	3-3/4	1-3/4	19.48
76	50B76	15.49	15.124	1	2-1/2	3-3/4	1-3/4	21.00
80	50B80	16.28	15.919	1	2-3/4	4-1/4	1-3/4	24.74
84	50B84	17.08	16.715	1	2-3/4	4-1/4	1-3/4	25.50
95	50B95	19.27	18.903	1	2-3/4	4-1/4	1-3/4	32.00
96	50B96	19.47	19.102	1	2-3/4	4-1/4	1-3/4	32.92
112	50B112	22.65	22.284	1	2-3/4	4-1/4	1-3/4	42.00

*Has recessed groove in the hub for chain clearance.
Sprockets with "H" prefix have hardened teeth.

NOTE: Maximum bores shown will accommodate a standard keyseat and a setscrew over the keyseat. Slightly larger bores are possible with no keyseat, a shallow keyseat, or a setscrew at an angle to the keyseat.