

# 50 Sprockets

## 5/8" Pitch

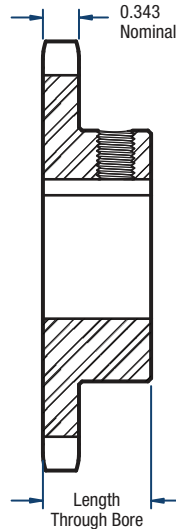

# BLACKSTAR®



### Single- Bored to Size— Keyway and 2 Setscrews (continued on next page)

No. of Teeth	Catalog Number	Diameters (in)		Length Through Bore (in)	Approx. Weight (lbs)	Stock Finished Bore Includes Keyway and 2 Setscrews													
		Outside	Pitch			5/8	3/4	7/8	1	1-1/8	1-3/16	1-1/4	1-3/8	1-7/16	1-1/2	1-5/8	1-3/4	1-15/16	
9	H50BS9	2.09	1.828	1	0.30	5/8	3/4	—	—	—	—	—	—	—	—	—	—	—	—
10	H50BS10	2.30	2.023	1	0.30	5/8	3/4	7/8	1	—	—	—	—	—	—	—	—	—	—
11	H50BS11	2.50	2.219	1	0.60	5/8	3/4	7/8	1	—	—	—	—	—	—	—	—	—	—
12	H50BS12	2.71	2.415	1	0.70	5/8	3/4	7/8	1	1-1/8	1-3/16	1-1/4	—	—	—	—	—	—	—
13	H50BS13	2.91	2.612	1	0.80	5/8	3/4	7/8	1	1-1/8	1-3/16	1-1/4	—	—	—	—	—	—	—
14	H50BS14	3.11	2.809	1	1.00	5/8	3/4	7/8	1	1-1/8	1-3/16	1-1/4	—	—	—	—	—	—	—
15	H50BS15	3.32	3.006	1	1.20	5/8	3/4	7/8	1	1-1/8	1-3/16	1-1/4	1-3/8	1-7/16	1-1/2	—	—	—	—
16	H50BS16	3.52	3.204	1	1.45	5/8	3/4	7/8	1	1-1/8	1-3/16	1-1/4	1-3/8	1-7/16	1-1/2	1-5/8	—	—	—
17	H50BS17	3.72	3.401	1	1.60	5/8	3/4	7/8	1	1-1/8	1-3/16	1-1/4	1-3/8	1-7/16	1-1/2	1-5/8	—	—	—
18	H50BS18	3.92	3.599	1	1.90	5/8	3/4	7/8	1	1-1/8	1-3/16	1-1/4	1-3/8	1-7/16	1-1/2	1-5/8	—	—	—
19	H50BS19	4.12	3.798	1	2.00	5/8	3/4	7/8	1	1-1/8	1-3/16	1-1/4	1-3/8	1-7/16	1-1/2	1-5/8	—	—	—
20	H50BS20	4.32	3.995	1	2.10	—	3/4	7/8	1	1-1/8	1-3/16	1-1/4	1-3/8	1-7/16	1-1/2	1-5/8	—	—	—
21	H50BS21	4.52	4.194	1	2.25	—	3/4	7/8	1	1-1/8	1-3/16	1-1/4	1-3/8	1-7/16	1-1/2	1-5/8	—	—	—
22	H50BS22	4.72	4.392	1	2.40	—	3/4	7/8	1	1-1/8	1-3/16	1-1/4	1-3/8	1-7/16	1-1/2	1-5/8	—	—	—
23	H50BS23	4.92	4.590	1	2.50	—	3/4	7/8	1	1-1/8	1-3/16	1-1/4	1-3/8	1-7/16	1-1/2	1-5/8	—	—	—
24	H50BS24	5.12	4.788	1-1/4	3.00	—	3/4	7/8	1	1-1/8	1-3/16	1-1/4	1-3/8	1-7/16	1-1/2	1-5/8	—	—	—
25	H50BS25	5.32	4.987	1-1/4	3.10	—	3/4	7/8	1	1-1/8	1-3/16	1-1/4	1-3/8	1-7/16	1-1/2	1-5/8	—	—	—
26	H50BS26	5.52	5.185	1-1/4	3.30	—	3/4	7/8	1	1-1/8	1-3/16	1-1/4	1-3/8	1-7/16	1-1/2	1-5/8	—	—	—
27	H50BS27	5.72	5.384	1-1/4	3.46	—	3/4	7/8	1	1-1/8	1-3/16	1-1/4	1-3/8	1-7/16	1-1/2	1-5/8	—	—	—
28	H50BS28	5.92	5.582	1-1/4	3.60	—	3/4	7/8	1	1-1/8	1-3/16	1-1/4	1-3/8	1-7/16	1-1/2	1-5/8	—	—	—
29	H50BS29	6.12	5.781	1-1/4	3.78	—	3/4	7/8	1	1-1/8	1-3/16	1-1/4	1-3/8	1-7/16	1-1/2	1-5/8	—	—	—
30	H50BS30	6.32	5.979	1-1/4	3.90	—	3/4	7/8	1	1-1/8	1-3/16	1-1/4	1-3/8	1-7/16	1-1/2	1-5/8	—	—	—
31	50BS31	6.52	6.178	1-1/4	4.46	—	3/4	7/8	1	1-1/8	1-3/16	1-1/4	1-3/8	1-7/16	1-1/2	1-5/8	1-3/4	1-15/16	—
32	50BS32	6.72	6.376	1-1/4	4.70	—	3/4	7/8	1	1-1/8	1-3/16	1-1/4	1-3/8	1-7/16	1-1/2	1-5/8	1-3/4	1-15/16	—
33	50BS33	6.92	6.575	1-1/4	4.92	—	3/4	7/8	1	1-1/8	1-3/16	1-1/4	1-3/8	1-7/16	1-1/2	1-5/8	1-3/4	1-15/16	—
34	50BS34	7.12	6.774	1-1/4	5.06	—	3/4	7/8	1	1-1/8	1-3/16	1-1/4	1-3/8	1-7/16	1-1/2	1-5/8	1-3/4	1-15/16	—
35	50BS35	7.32	6.973	1-1/4	5.30	—	3/4	7/8	1	1-1/8	1-3/16	1-1/4	1-3/8	1-7/16	1-1/2	1-5/8	1-3/4	1-15/16	—
36	50BS36	7.52	7.171	1-1/4	5.50	—	3/4	7/8	1	1-1/8	1-3/16	1-1/4	1-3/8	1-7/16	1-1/2	1-5/8	1-3/4	1-15/16	—
37	50BS37	7.72	7.370	1-1/4	5.62	—	3/4	7/8	1	1-1/8	1-3/16	1-1/4	1-3/8	1-7/16	1-1/2	1-5/8	1-3/4	1-15/16	—

\*Indicates no keyway and (2) 1/4" setscrews only.

**NOTE:** Keyway is on center line of tooth.

\*\*Keyway with only one setscrew at 90 degrees.  
Hub diameters may vary to suit different bore sizes.

Sprockets with "H" prefix have hardened teeth.

# 50 Sprockets

## 5/8" Pitch



# BLACKSTAR®

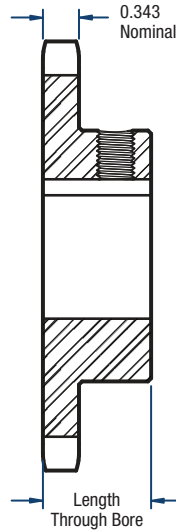

### Single- Bored to Size— Keyway and 2 Setscrews (continued)

No. of Teeth	Catalog Number	Diameters (in)		Length Through Bore (in)	Approx. Weight (lbs)	Stock Finished Bore Includes Keyway and 2 Setscrews												
		Outside	Pitch			3/4	7/8	1	1-1/8	1-3/16	1-1/4	1-3/8	1-7/16	1-1/2	1-5/8	1-3/4	1-15/16	
38	50BS38	7.92	7.569	1-1/4	5.80	—	3/4	7/8	1	1-1/8	1-3/16	1-1/4	1-3/8	1-7/16	1-1/2	1-5/8	1-3/4	1-15/16
39	50BS39	8.12	7.768	1-1/4	6.02	—	3/4	7/8	1	1-1/8	1-3/16	1-1/4	1-3/8	1-7/16	1-1/2	1-5/8	1-3/4	1-15/16
40	50BS40	8.32	7.966	1-1/4	6.20	—	3/4	7/8	1	1-1/8	1-3/16	1-1/4	1-3/8	1-7/16	1-1/2	1-5/8	1-3/4	1-15/16
41	50BS41	8.52	8.165	1-1/4	6.45	—	3/4	7/8	1	1-1/8	1-3/16	1-1/4	1-3/8	1-7/16	1-1/2	1-5/8	1-3/4	1-15/16
42	50BS42	8.72	8.364	1-1/4	6.68	—	3/4	7/8	1	1-1/8	1-3/16	1-1/4	1-3/8	1-7/16	1-1/2	1-5/8	1-3/4	1-15/16
43	50BS43	8.91	8.563	1-1/4	6.99	—	3/4	7/8	1	1-1/8	1-3/16	1-1/4	1-3/8	1-7/16	1-1/2	1-5/8	1-3/4	1-15/16
44	50BS44	9.11	8.761	1-1/4	7.30	—	3/4	7/8	1	1-1/8	1-3/16	1-1/4	1-3/8	1-7/16	1-1/2	1-5/8	1-3/4	1-15/16
45	50BS45	9.31	8.960	1-1/4	8.00	—	3/4	7/8	1	1-1/8	1-3/16	1-1/4	1-3/8	1-7/16	1-1/2	1-5/8	1-3/4	1-15/16
46	50BS46	9.51	9.159	1-1/4	8.51	—	—	—	1	1-1/8	1-3/16	1-1/4	1-3/8	1-7/16	1-1/2	1-5/8	1-3/4	1-15/16
47	50BS47	9.71	9.358	1-1/4	8.76	—	—	—	1	1-1/8	1-3/16	1-1/4	1-3/8	1-7/16	1-1/2	1-5/8	1-3/4	1-15/16
48	50BS48	9.91	9.556	1-1/4	9.03	—	—	—	1	1-1/8	1-3/16	1-1/4	1-3/8	1-7/16	1-1/2	1-5/8	1-3/4	1-15/16
49	50BS49	10.11	9.755	1-1/4	9.33	—	—	—	1	1-1/8	1-3/16	1-1/4	1-3/8	1-7/16	1-1/2	1-5/8	1-3/4	1-15/16
50	50BS50	10.31	9.954	1-1/4	9.63	—	—	—	1	1-1/8	1-3/16	1-1/4	1-3/8	1-7/16	1-1/2	1-5/8	1-3/4	1-15/16
51	50BS51	10.51	10.153	1-1/4	9.81	—	—	—	1	1-1/8	1-3/16	1-1/4	1-3/8	1-7/16	1-1/2	1-5/8	1-3/4	1-15/16
52	50BS52	10.71	10.351	1-1/4	9.99	—	—	—	1	1-1/8	1-3/16	1-1/4	1-3/8	1-7/16	1-1/2	1-5/8	1-3/4	1-15/16
53	50BS53	10.91	10.550	1-1/4	10.37	—	—	—	1	1-1/8	1-3/16	1-1/4	1-3/8	1-7/16	1-1/2	1-5/8	1-3/4	1-15/16
54	50BS54	11.11	10.749	1-1/4	10.75	—	—	—	1	1-1/8	1-3/16	1-1/4	1-3/8	1-7/16	1-1/2	1-5/8	1-3/4	1-15/16
55	50BS55	11.31	10.948	1-1/4	11.08	—	—	—	1	1-1/8	1-3/16	1-1/4	1-3/8	1-7/16	1-1/2	1-5/8	1-3/4	1-15/16
56	50BS56	11.50	11.147	1-1/4	11.41	—	—	—	1	1-1/8	1-3/16	1-1/4	1-3/8	1-7/16	1-1/2	1-5/8	1-3/4	1-15/16
57	50BS57	11.70	11.346	1-1/4	11.75	—	—	—	1	1-1/8	1-3/16	1-1/4	1-3/8	1-7/16	1-1/2	1-5/8	1-3/4	1-15/16
58	50BS58	11.90	11.544	1-1/4	12.08	—	—	—	1	1-1/8	1-3/16	1-1/4	1-3/8	1-7/16	1-1/2	1-5/8	1-3/4	1-15/16
59	50BS59	12.10	11.743	1-1/4	12.41	—	—	—	1	1-1/8	1-3/16	1-1/4	1-3/8	1-7/16	1-1/2	1-5/8	1-3/4	1-15/16
60	50BS60	12.30	11.942	1-1/4	13.50	—	—	—	1	1-1/8	1-3/16	1-1/4	1-3/8	1-7/16	1-1/2	1-5/8	1-3/4	1-15/16
70	50BS70	14.29	13.931	1-3/4	17.81	—	—	—	1	1-1/8	1-3/16	1-1/4	1-3/8	1-7/16	1-1/2	1-5/8	1-3/4	1-15/16
72	50BS72	14.69	14.329	1-3/4	19.13	—	—	—	1	1-1/8	1-3/16	1-1/4	1-3/8	1-7/16	1-1/2	1-5/8	1-3/4	1-15/16
80	50BS80	16.28	15.919	1-3/4	24.39	—	—	—	1	1-1/8	1-3/16	1-1/4	1-3/8	1-7/16	1-1/2	1-5/8	1-3/4	1-15/16
84	50BS84	17.08	16.715	1-3/4	25.15	—	—	—	1	1-1/8	1-3/16	1-1/4	1-3/8	1-7/16	1-1/2	1-5/8	1-3/4	1-15/16
96	50BS96	19.47	19.102	1-3/4	32.57	—	—	—	1	1-1/8	1-3/16	1-1/4	1-3/8	1-7/16	1-1/2	1-5/8	1-3/4	1-15/16
112	50BS112	22.65	22.284	1-3/4	41.65	—	—	—	1	1-1/8	1-3/16	1-1/4	1-3/8	1-7/16	1-1/2	1-5/8	1-3/4	1-15/16

\*Indicates no keyway and (2) 1/4" setscrews only.

**NOTE:** Keyway is on center line of tooth.

\*\*Keyway with only one setscrew at 90 degrees.  
Hub diameters may vary to suit different bore sizes.

Sprockets with "H" prefix have hardened teeth.