

# 50 Sprockets

## 5/8" Pitch

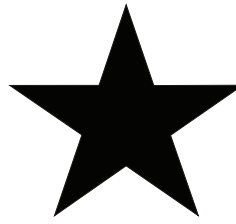

# BLACKSTAR®

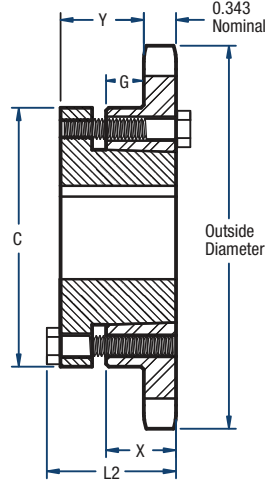

**TYPE B**

### Single- QD Style

No. of Teeth	Catalog Number	Bushing	Diameters (in)		Type	Max. Bore	Dimensions (in)					Approx. Weight (lbs)	
			Outside	Pitch			L2	C	Y	G	X	Bushing Only	Sprocket Only
12	H50JA12	JA	2.71	2.415	B	1-1/4	1-1/8	2-1/16	21/32	9/32	5/8	0.9	0.3
13	H50JA13	JA	2.91	2.612	B	1-1/4	1-1/8	2-1/16	21/32	9/32	5/8	0.9	0.4
14	H50JA14	JA	3.11	2.809	B	1-1/4	1-1/8	2-1/16	21/32	9/32	5/8	0.9	0.5
15	H50JA15	JA	3.32	3.006	B	1-1/4	1-1/8	2-1/16	21/32	9/32	5/8	0.9	0.6
16	H50JA16	JA	3.52	3.204	B	1-1/4	1-1/8	2-1/16	21/32	9/32	5/8	0.9	0.7
17	H50SH17	SH	3.72	3.401	B	1-5/8	1-7/16	2-11/16	29/32	15/32	13/16	1.0	0.8
18	H50SH18	SH	3.92	3.599	B	1-5/8	1-7/16	2-11/16	29/32	15/32	13/16	1.0	1.0
19	H50SH19	SH	4.12	3.798	B	1-5/8	1-7/16	2-11/16	29/32	15/32	13/16	1.0	1.2
20	H50SDS20	SDS	4.32	3.995	B	2	1-1/2	3-3/16	31/32	13/32	3/4	1.0	1.2
21	H50SDS21	SDS	4.52	4.194	B	2	1-1/2	3-3/16	31/32	13/32	3/4	1.0	1.3
22	H50SDS22	SDS	4.72	4.392	B	2	1-1/2	3-3/16	31/32	13/32	3/4	1.0	1.4
23	H50SDS23	SDS	4.92	4.590	B	2	1-1/2	3-3/16	31/32	13/32	3/4	1.0	1.6
24	H50SDS24	SDS	5.12	4.788	B	2	1-1/2	3-3/16	31/32	13/32	3/4	1.0	1.7
25	H50SDS25	SDS	5.32	4.987	B	2	1-1/2	3-3/16	31/32	13/32	3/4	1.0	1.8
26	H50SDS26	SDS	5.52	5.185	B	2	1-1/2	3-3/16	31/32	13/32	3/4	1.0	2.0
27	H50SDS27	SDS	5.72	5.384	B	2	1-1/2	3-3/16	31/32	13/32	3/4	1.0	2.1
28	H50SDS28	SDS	5.92	5.582	B	2	1-1/2	3-3/16	31/32	13/32	3/4	1.0	2.3
30	H50SDS30	SDS	6.32	5.979	B	2	1-1/2	3-3/16	31/32	13/32	3/4	1.0	2.6
32	50SDS32	SDS	6.72	6.376	B	2	1-1/2	3-3/16	31/32	13/32	3/4	1.0	3.0
35	50SDS35	SDS	7.32	6.973	B	2	1-1/2	3-3/16	31/32	13/32	3/4	1.0	3.6
36	50SDS36	SDS	7.52	7.171	B	2	1-1/2	3-3/16	31/32	13/32	3/4	1.0	3.6
40	50SDS40	SDS	8.32	7.966	B	2	1-1/2	3-3/16	31/32	13/32	3/4	1.0	4.7
42	50SDS42	SDS	8.72	8.364	B	2	1-1/2	3-3/16	31/32	13/32	3/4	1.0	5.4
45	50SDS45	SDS	9.31	8.960	B	2	1-1/2	3-3/16	31/32	13/32	3/4	1.0	5.9
48	50SDS48	SDS	9.91	9.556	B	2	1-1/2	3-3/16	31/32	13/32	3/4	1.0	6.7
54	50SK54	SK	11.11	10.749	B	2-5/8	2-1/8	3-7/8	1-17/32	29/32	1-1/4	2.0	9.7
60	50SK60	SK	12.30	11.942	B	2-5/8	2-1/8	3-7/8	1-17/32	29/32	1-1/4	2.0	11.9
70	50SK70	SK	14.29	13.931	B	2-5/8	2-1/8	3-7/8	1-17/32	29/32	1-1/4	2.0	15.5
72	50SK72	SK	14.69	14.329	B	2-5/8	2-1/8	3-7/8	1-17/32	29/32	1-1/4	2.0	16.4
80	50SF80	SF	16.28	15.919	B	2-15/16	2-1/4	4-5/8	1-21/32	29/32	1-1/4	3.0	19.9
84	50SF84	SF	17.08	16.715	B	2-15/16	2-1/4	4-5/8	1-21/32	29/32	1-1/4	3.0	23.0
96	50SF96	SF	19.47	19.102	B	2-15/16	2-1/4	4-5/8	1-21/32	29/32	1-1/4	3.0	29.9
112	50SF112	SF	22.65	22.284	B	2-15/16	2-1/4	4-5/8	1-21/32	29/32	1-1/4	3.0	40.1

**NOTE:** Maximum bores shown will accommodate a standard keyseat and a setscrew over the keyseat. Slightly larger bores are possible with no keyseat, a shallow keyseat, or a setscrew at an angle to the keyseat.