

60 Sprockets

3/4" Pitch

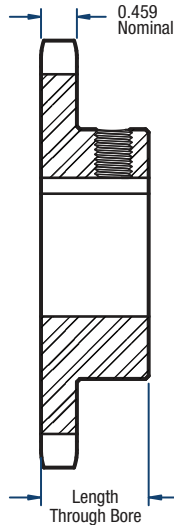

BLACKSTAR®



Single- Bored to Size— Keyway and 2 Setscrews (continued on next page)

No. of Teeth	Catalog Number	Diameters (in)		Length Through Bore (in)	Approx. Weight (lbs)	Stock Finished Bore Includes Keyway and 2 Setscrews														
		Outside	Pitch			3/4	7/8	1	1-1/8	1-3/16	1-1/4	1-3/8	1-7/16	1-1/2	1-5/8	1-3/4	1-15/16	2	2-3/16	2-7/16
9	H60BS9	2.51	2.193	1-1/4	0.6	3/4	7/8	1	—	—	—	—	—	—	—	—	—	—	—	—
10	H60BS10	2.76	2.427	1-1/4	0.7	3/4	7/8	1	1-1/8	1-3/16	1-1/4	—	—	—	—	—	—	—	—	—
11	H60BS11	3.00	2.663	1-1/4	0.9	3/4	7/8	1	1-1/8	1-3/16	1-1/4	—	—	—	—	—	—	—	—	—
12	H60BS12	3.25	2.898	1-1/4	1.3	3/4	7/8	1	1-1/8	1-3/16	1-1/4	—	1-7/16	—	—	—	—	—	—	—
13	H60BS13	3.49	3.134	1-1/4	1.3	3/4	7/8	1	1-1/8	1-3/16	1-1/4	1-3/8	1-7/16	1-1/2	1-5/8	—	—	—	—	—
14	H60BS14	3.74	3.371	1-1/4	1.6	3/4	7/8	1	1-1/8	1-3/16	1-1/4	1-3/8	1-7/16	1-1/2	1-5/8	—	—	—	—	—
15	H60BS15	3.98	3.608	1-1/4	1.7	3/4	7/8	1	1-1/8	1-3/16	1-1/4	1-3/8	1-7/16	1-1/2	1-5/8	1-3/4	—	—	—	—
16	H60BS16	4.22	3.845	1-1/4	2.1	3/4	7/8	1	1-1/8	1-3/16	1-1/4	1-3/8	1-7/16	1-1/2	1-5/8	1-3/4	1-15/16	—	—	—
17	H60BS17	4.46	4.082	1-1/4	2.4	—	—	1	1-1/8	1-3/16	1-1/4	1-3/8	1-7/16	1-1/2	1-5/8	1-3/4	1-15/16	—	—	—
18	H60BS18	4.70	4.319	1-1/4	2.6	—	—	1	1-1/8	1-3/16	1-1/4	1-3/8	1-7/16	1-1/2	1-5/8	1-3/4	1-15/16	—	—	—
19	H60BS19	4.95	4.557	1-1/4	3.4	—	—	1	1-1/8	1-3/16	1-1/4	1-3/8	1-7/16	1-1/2	1-5/8	1-3/4	1-15/16	—	—	—
20	H60BS20	5.19	4.794	1-1/4	3.9	—	—	1	1-1/8	1-3/16	1-1/4	1-3/8	1-7/16	1-1/2	1-5/8	1-3/4	1-15/16	—	—	—
21	H60BS21	5.43	5.033	1-1/4	4.4	—	—	1	1-1/8	1-3/16	1-1/4	1-3/8	1-7/16	1-1/2	1-5/8	1-3/4	1-15/16	—	—	—
22	H60BS22	5.67	5.270	1-1/4	4.7	—	—	1	1-1/8	1-3/16	1-1/4	1-3/8	1-7/16	1-1/2	1-5/8	1-3/4	1-15/16	—	—	—
23	H60BS23	5.91	5.508	1-1/4	5.0	—	—	1	1-1/8	1-3/16	1-1/4	1-3/8	1-7/16	1-1/2	1-5/8	1-3/4	1-15/16	—	—	—
24	H60BS24	6.15	5.746	1-1/4	5.3	—	—	1	1-1/8	1-3/16	1-1/4	1-3/8	1-7/16	1-1/2	1-5/8	1-3/4	1-15/16	—	—	—
25	H60BS25	6.39	5.984	1-1/4	5.4	—	—	1	1-1/8	1-3/16	1-1/4	1-3/8	1-7/16	1-1/2	1-5/8	1-3/4	1-15/16	—	—	—
26	H60BS26	6.63	6.222	1-1/4	5.8	—	—	1	1-1/8	1-3/16	1-1/4	1-3/8	1-7/16	1-1/2	1-5/8	1-3/4	1-15/16	—	—	—
27	H60BS27	6.87	6.461	1-1/4	6.3	—	—	1	1-1/8	1-3/16	1-1/4	1-3/8	1-7/16	1-1/2	1-5/8	1-3/4	1-15/16	—	—	—
28	H60BS28	7.11	6.698	1-1/4	6.4	—	—	1	1-1/8	1-3/16	1-1/4	1-3/8	1-7/16	1-1/2	1-5/8	1-3/4	1-15/16	—	—	—
29	H60BS29	7.35	6.937	1-1/4	6.9	—	—	1	1-1/8	1-3/16	1-1/4	1-3/8	1-7/16	1-1/2	1-5/8	1-3/4	1-15/16	—	—	—
30	H60BS30	7.59	7.175	1-1/4	7.1	—	—	1	1-1/8	1-3/16	1-1/4	1-3/8	1-7/16	1-1/2	1-5/8	1-3/4	1-15/16	—	—	—
31	60BS31	7.83	7.413	1-1/4	7.4	—	—	1	1-1/8	1-3/16	1-1/4	1-3/8	1-7/16	1-1/2	1-5/8	1-3/4	1-15/16	—	—	—
32	60BS32	8.07	7.652	1-1/4	7.8	—	—	1	1-1/8	1-3/16	1-1/4	1-3/8	1-7/16	1-1/2	1-5/8	1-3/4	1-15/16	—	—	—
33	60BS33	8.31	7.890	1-1/4	8.2	—	—	1	1-1/8	1-3/16	1-1/4	1-3/8	1-7/16	1-1/2	1-5/8	1-3/4	1-15/16	—	—	—
34	60BS34	8.54	8.129	1-1/4	8.5	—	—	1	1-1/8	1-3/16	1-1/4	1-3/8	1-7/16	1-1/2	1-5/8	1-3/4	1-15/16	—	—	—
35	60BS35	8.78	8.367	1-1/4	8.8	—	—	1	1-1/8	1-3/16	1-1/4	1-3/8	1-7/16	1-1/2	1-5/8	1-3/4	1-15/16	—	—	—
36	60BS36	9.02	8.606	1-1/4	9.2	—	—	1	1-1/8	1-3/16	1-1/4	1-3/8	1-7/16	1-1/2	1-5/8	1-3/4	1-15/16	2	2-3/16	2-7/16
37	60BS37	9.26	8.844	1-1/4	9.9	—	—	1	1-1/8	1-3/16	1-1/4	1-3/8	1-7/16	1-1/2	1-5/8	1-3/4	1-15/16	2	2-3/16	2-7/16
38	60BS38	9.50	9.083	1-1/4	10.5	—	—	1	1-1/8	1-3/16	1-1/4	1-3/8	1-7/16	1-1/2	1-5/8	1-3/4	1-15/16	2	2-3/16	2-7/16

Hub diameters vary to suit different bore sizes.
Sprockets with "H" prefix have hardened teeth.

60 Sprockets

3/4" Pitch

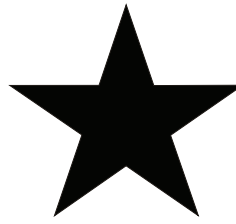

BLACKSTAR®

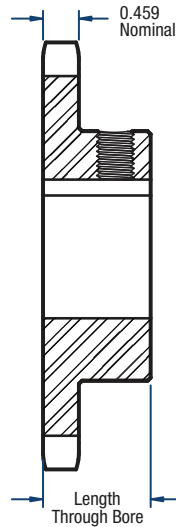

Single- Bored to Size— Keyway and 2 Setscrews (continued)

No. of Teeth	Catalog Number	Diameters (in)		Length Through Bore (in)	Approx. Weight (lbs)	Stock Finished Bore Includes Keyway and 2 Setscrews														
		Outside	Pitch																	
39	60BS39	9.74	9.321	1-1/4	10.9	—	—	1	1-1/8	1-3/16	1-1/4	1-3/8	1-7/16	1-1/2	1-5/8	1-3/4	1-15/16	2	2-3/16	2-7/16
40	60BS40	9.98	9.560	1-1/4	11.2	—	—	1	1-1/8	1-3/16	1-1/4	1-3/8	1-7/16	1-1/2	1-5/8	1-3/4	1-15/16	2	2-3/16	2-7/16
41	60BS41	10.22	9.798	1-1/4	11.8	—	—	1	1-1/8	1-3/16	1-1/4	1-3/8	1-7/16	1-1/2	1-5/8	1-3/4	1-15/16	2	2-3/16	2-7/16
42	60BS42	10.46	10.037	1-1/4	12.4	—	—	1	1-1/8	1-3/16	1-1/4	1-3/8	1-7/16	1-1/2	1-5/8	1-3/4	1-15/16	2	2-3/16	2-7/16
43	60BS43	10.70	10.275	1-1/4	13.0	—	—	1	1-1/8	1-3/16	1-1/4	1-3/8	1-7/16	1-1/2	1-5/8	1-3/4	1-15/16	2	2-3/16	2-7/16
44	60BS44	10.94	10.514	1-1/4	13.5	—	—	1	1-1/8	1-3/16	1-1/4	1-3/8	1-7/16	1-1/2	1-5/8	1-3/4	1-15/16	2	2-3/16	2-7/16
45	60BS45	11.18	10.752	1-1/4	13.8	—	—	1	1-1/8	1-3/16	1-1/4	1-3/8	1-7/16	1-1/2	1-5/8	1-3/4	1-15/16	2	2-3/16	2-7/16
46	60BS46	11.41	10.991	1-1/4	14.1	—	—	1	1-1/8	1-3/16	1-1/4	1-3/8	1-7/16	1-1/2	1-5/8	1-3/4	1-15/16	2	2-3/16	2-7/16
47	60BS47	11.65	11.229	1-1/4	14.6	—	—	1	1-1/8	1-3/16	1-1/4	1-3/8	1-7/16	1-1/2	1-5/8	1-3/4	1-15/16	2	2-3/16	2-7/16
48	60BS48	11.89	11.468	1-1/4	15.4	—	—	1	1-1/8	1-3/16	1-1/4	1-3/8	1-7/16	1-1/2	1-5/8	1-3/4	1-15/16	2	2-3/16	2-7/16
49	60BS49	12.13	11.706	1-1/4	16.4	—	—	1	1-1/8	1-3/16	1-1/4	1-3/8	1-7/16	1-1/2	1-5/8	1-3/4	1-15/16	2	2-3/16	2-7/16
50	60BS50	12.37	11.945	1-1/4	17.3	—	—	1	1-1/8	1-3/16	1-1/4	1-3/8	1-7/16	1-1/2	1-5/8	1-3/4	1-15/16	2	2-3/16	2-7/16
51	60BS51	12.61	12.183	1-1/4	18.3	—	—	1	1-1/8	1-3/16	1-1/4	1-3/8	1-7/16	1-1/2	1-5/8	1-3/4	1-15/16	2	2-3/16	2-7/16
52	60BS52	12.85	12.422	1-1/4	19.3	—	—	1	1-1/8	1-3/16	1-1/4	1-3/8	1-7/16	1-1/2	1-5/8	1-3/4	1-15/16	2	2-3/16	2-7/16
53	60BS53	13.09	12.660	1-1/4	20.3	—	—	1	1-1/8	1-3/16	1-1/4	1-3/8	1-7/16	1-1/2	1-5/8	1-3/4	1-15/16	2	2-3/16	2-7/16
54	60BS54	13.33	12.899	1-3/4	21.0	—	—	1	1-1/8	1-3/16	1-1/4	1-3/8	1-7/16	1-1/2	1-5/8	1-3/4	1-15/16	2	2-3/16	2-7/16
55	60BS55	13.57	13.137	1-3/4	21.2	—	—	—	—	—	—	1-3/8	1-7/16	1-1/2	1-5/8	1-3/4	1-15/16	2	2-3/16	2-7/16
56	60BS56	13.81	13.376	1-3/4	21.3	—	—	—	—	—	—	1-3/8	1-7/16	1-1/2	1-5/8	1-3/4	1-15/16	2	2-3/16	2-7/16
57	60BS57	14.04	13.615	1-3/4	22.2	—	—	—	—	—	—	1-3/8	1-7/16	1-1/2	1-5/8	1-3/4	1-15/16	2	2-3/16	2-7/16
58	60BS58	14.28	13.853	1-3/4	23.0	—	—	—	—	—	—	1-3/8	1-7/16	1-1/2	1-5/8	1-3/4	1-15/16	2	2-3/16	2-7/16
59	60BS59	14.52	14.092	1-3/4	23.8	—	—	—	—	—	—	1-3/8	1-7/16	1-1/2	1-5/8	1-3/4	1-15/16	2	2-3/16	2-7/16
60	60BS60	14.76	14.330	1-3/4	25.0	—	—	—	—	—	—	1-3/8	1-7/16	1-1/2	1-5/8	1-3/4	1-15/16	2	2-3/16	2-7/16
70	60BS70	17.15	16.717	1-3/4	31.4	—	—	—	—	—	—	1-3/8	1-7/16	1-1/2	1-5/8	1-3/4	1-15/16	2	2-3/16	2-7/16
72	60BS72	17.63	17.195	1-3/4	33.5	—	—	—	—	—	—	1-3/8	1-7/16	1-1/2	1-5/8	1-3/4	1-15/16	2	2-3/16	2-7/16
80	60BS80	19.54	19.103	1-3/4	41.2	—	—	—	—	—	—	1-3/8	1-7/16	1-1/2	1-5/8	1-3/4	1-15/16	2	2-3/16	2-7/16
84	60BS84	20.49	20.058	1-3/4	45.8	—	—	—	—	—	—	1-3/8	1-7/16	1-1/2	1-5/8	1-3/4	1-15/16	2	2-3/16	2-7/16
96	60BS96	23.36	22.922	1-3/4	62.3	—	—	—	—	—	—	1-3/8	1-7/16	1-1/2	1-5/8	1-3/4	1-15/16	2	2-3/16	2-7/16
112	60BS112	27.18	26.741	1-3/4	81.0	—	—	—	—	—	—	1-3/8	1-7/16	1-1/2	1-5/8	1-3/4	1-15/16	2	2-3/16	2-7/16

Hub diameters vary to suit different bore sizes.
Sprockets with "H" prefix have hardened teeth.