

78/81X Sprockets

78— 2.609" Pitch

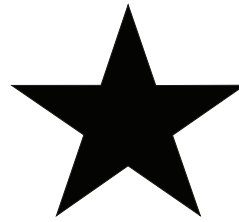

BLACKSTAR®

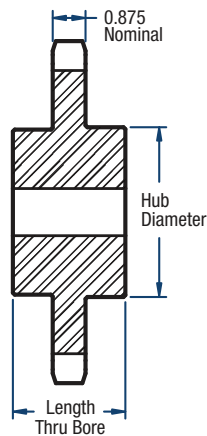

TYPE C

78- Type C

No. of Teeth	Catalog Number	Pitch Diameter (in)	Bore		Hub Diameter	Length Through Bore
			Minimum	Maximum		
8	78C8	6.82	15/16	3-1/4	4-3/4	3
9	78C9	7.63	1-1/4	3-7/16	5-1/4	3
10	78C10	8.44	1-1/4	3-7/16	5-1/4	3
11	78C11	9.26	1-1/4	3-7/16	5-1/4	3
12	78C12	10.08	1-1/4	3-7/16	5-1/4	3
13	78C13	10.90	1-1/4	3-3/4	5-1/2	3
14	78C14	11.72	1-1/4	3-3/4	5-1/2	3
15	78C15	12.55	1-1/2	3-3/4	5-1/2	3
17	78C17	14.20	1-1/2	3-3/4	5-1/2	3

NOTE: Maximum bores shown will accommodate a standard keyseat and a setscrew over the keyseat. Slightly larger bores are possible with no keyseat, a shallow keyseat, or a setscrew at an angle to the keyseat.