

80 Sprockets

1" Pitch

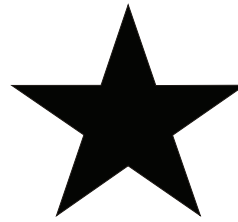

BLACKSTAR®

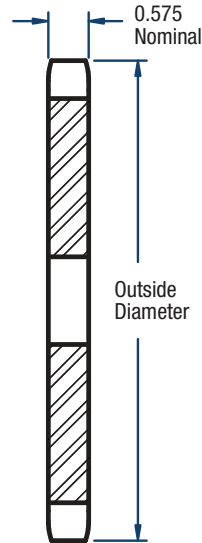

TYPE A

Single- Type A

No. of Teeth	Catalog Number	Diameters (in)		Stock Bore (in)	Approx. Weight (lbs)
		Outside	Pitch		
9	H80A9	3.35	2.924	15/16	0.8
10	H80A10	3.68	3.236	15/16	1.0
11	H80A11	4.01	3.550	15/16	1.3
12	H80A12	4.33	3.864	15/16	1.5
13	H80A13	4.66	4.179	15/16	1.8
14	H80A14	4.98	4.494	15/16	2.2
15	H80A15	5.30	4.810	15/16	2.5
16	H80A16	5.63	5.126	15/16	2.9
17	H80A17	5.95	5.442	15/16	3.3
18	H80A18	6.27	5.759	15/16	3.7
19	H80A19	6.59	6.076	15/16	4.1
20	H80A20	6.91	6.392	15/16	4.7
21	H80A21	7.24	6.710	15/16	4.9
22	H80A22	7.56	7.027	15/16	5.5
23	H80A23	7.88	7.344	15/16	6.3
24	H80A24	8.20	7.661	15/16	6.7
25	H80A25	8.52	7.979	15/16	7.2
26	H80A26	8.84	8.296	1-3/16	7.8
27	H80A27	9.16	8.614	1-3/16	8.6
28	H80A28	9.48	8.931	1-3/16	9.3
29	H80A29	9.80	9.249	1-3/16	9.8
30	H80A30	10.11	9.567	1-3/16	10.7
31	80A31	10.43	9.884	1-3/16	11.3
32	80A32	10.75	10.202	1-3/16	12.1
33	80A33	11.07	10.520	1-3/16	13.6
34	80A34	11.39	10.838	1-3/16	14.3
35	80A35	11.71	11.156	1-3/16	14.8
36	80A36	12.03	11.474	1-3/16	16.1
37	80A37	12.35	11.792	1-3/16	16.8
38	80A38	12.67	12.110	1-3/16	17.2
39	80A39	12.99	12.428	1-3/16	17.9

No. of Teeth	Catalog Number	Diameters (in)		Stock Bore (in)	Approx. Weight (lbs)
		Outside	Pitch		
40	80A40	13.31	12.746	1-3/16	18.9
41	80A41	13.63	13.064	1-1/4	21.0
42	80A42	13.94	13.382	1-1/4	21.8
43	80A43	14.26	13.700	1-1/4	23.6
44	80A44	14.58	14.018	1-1/4	24.3
45	80A45	14.90	14.336	1-1/4	25.2
46	80A46	15.22	14.654	1-1/4	26.6
47	80A47	15.54	14.972	1-1/4	26.4
48	80A48	15.86	15.290	1-1/4	27.8
49	80A49	16.18	15.608	1-1/4	28.9
50	80A50	16.50	15.926	1-1/4	30.9
51	80A51	16.81	16.244	1-1/4	32.2
52	80A52	17.13	16.562	1-1/4	33.0
53	80A53	17.45	16.880	1-1/4	34.9
54	80A54	17.77	17.198	1-1/4	36.6
55	80A55	18.09	17.516	1-1/4	37.5
56	80A56	18.41	17.835	1-1/4	39.4
57	80A57	18.73	18.153	1-1/4	40.4
58	80A58	19.04	18.471	1-1/4	41.3
59	80A59	19.36	18.789	1-1/4	42.9
60	80A60	19.68	19.107	1-1/4	45.3
65	80A65	21.27	20.698	1-1/4	52.2
70	80A70	22.87	22.289	1-1/2	59.8
72	80A72	23.50	22.926	1-1/2	65.7
76	80A76	24.78	24.198	1-1/2	70.2
80	80A80	26.05	25.471	1-1/2	79.6
84	80A84	27.33	26.744	1-1/2	86.1
90	80A90	29.24	28.654	1-1/2	101.0
96	80A96	31.15	30.563	1-1/2	120.0
112	80A112	36.24	35.655	1-1/2	165.0

Sprockets with "H" prefix have hardened teeth.