

# 80 Sprockets

## 1" Pitch

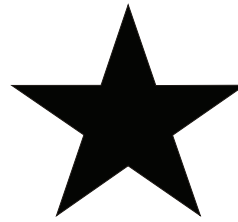

# BLACKSTAR®

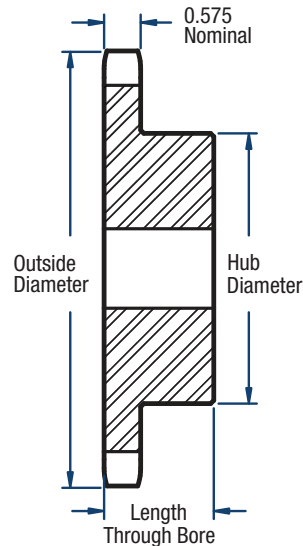

**TYPE B**

### Single- Type B (continued on the next page)

No. of Teeth	Catalog Number	Diameters (in)		Bore (in)		Hub (in)		Approx. Weight (lbs)
		Outside	Pitch	Min.	Max.	Diameter	Length Through Bore	
8	H80B8	3.01	2.613	1	1	1-15/16*	1-5/8	1.4
9	H80B9	3.35	2.924	1	1-5/16	2-1/4*	1-5/8	1.6
10	H80B10	3.68	3.236	1	1-1/2	2-9/16*	1-5/8	2.2
11	H80B11	4.01	3.550	1	1-5/8	2-13/16*	1-5/8	3.2
12	H80B12	4.33	3.864	1	1-7/8	3-1/8*	1-5/8	3.4
13	H80B13	4.66	4.179	1	2	3	1-1/2	3.5
14	H80B14	4.98	4.494	1	2-1/4	3-1/4	1-1/2	4.1
15	H80B15	5.30	4.810	1	2-1/2	3-13/16	1-1/2	5.3
16	H80B16	5.63	5.126	1	2-3/4	4	1-1/2	5.9
17	H80B17	5.95	5.442	1	2-3/4	4	1-1/2	6.6
18	H80B18	6.27	5.759	1	2-3/4	4-1/4	1-1/2	7.3
19	H80B19	6.59	6.076	1	2-3/4	4-1/4	1-1/2	7.8
20	H80B20	6.91	6.392	1	2-3/4	4-1/4	1-1/2	8.4
21	H80B21	7.24	6.710	1	2-3/4	4-1/4	1-3/4	9.4
22	H80B22	7.56	7.027	1	2-3/4	4-1/4	1-3/4	10.0
23	H80B23	7.88	7.344	1	2-3/4	4-1/4	1-3/4	10.7
24	H80B24	8.20	7.661	1	2-3/4	4-1/4	1-3/4	11.3
25	H80B25	8.52	7.979	1	2-3/4	4-1/4	1-3/4	11.9
26	H80B26	8.84	8.296	1-1/4	3-1/4	4-3/4	2	14.3
27	H80B27	9.16	8.614	1-1/4	3-1/4	4-3/4	2	15.4
28	H80B28	9.48	8.931	1-1/4	3-1/4	4-3/4	2	16.0
29	H80B29	9.80	9.249	1-3/16	3-1/4	4-3/4	2	17.1
30	H80B30	10.11	9.567	1-3/16	3-1/4	4-3/4	2	17.4
31	80B31	10.43	9.884	1-3/16	3-1/4	4-3/4	2	18.7
32	80B32	10.75	10.202	1-3/16	3-1/4	4-3/4	2	19.5
33	80B33	11.07	10.520	1-3/16	3-1/4	4-3/4	2	19.6
34	80B34	11.39	10.838	1-3/16	3-1/4	4-3/4	2	21.3

\*Has recessed groove in the hub for chain clearance.  
Sprockets with "H" prefix have hardened teeth.

**NOTE:** Maximum bores shown will accommodate a standard keyseat and a setscrew over the keyseat. Slightly larger bores are possible with no keyseat, a shallow keyseat, or a setscrew at an angle to the keyseat.

# 80 Sprockets

## 1" Pitch



# BLACKSTAR®

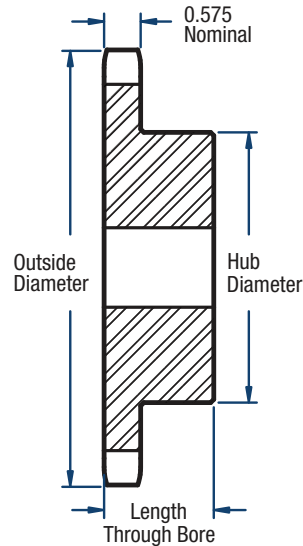

**TYPE B**

### Single- Type B (continued)

No. of Teeth	Catalog Number	Diameters (in)		Bore (in)		Hub (in)		Approx. Weight (lbs)
		Outside	Pitch	Min.	Max.	Diameter	Length Through Bore	
35	80B35	11.71	11.156	1-3/16	3-1/4	4-3/4	2	22.1
36	80B36	12.03	11.474	1-3/16	3-1/4	4-3/4	2	23.1
37	80B37	12.35	11.792	1-3/16	3-1/4	4-3/4	2	23.8
38	80B38	12.67	12.110	1-3/16	3-1/4	4-3/4	2	24.7
39	80B39	12.99	12.428	1-3/16	3-1/4	4-3/4	2	25.6
40	80B40	13.31	12.746	1-3/16	3-1/4	4-3/4	2	26.7
41	80B41	13.63	13.064	1-1/4	3-1/4	4-3/4	2	27.8
42	80B42	13.94	13.382	1-1/4	3-1/4	4-3/4	2	28.7
43	80B43	14.26	13.700	1-1/4	3-1/4	4-3/4	2	29.4
44	80B44	14.58	14.018	1-1/4	3-1/4	4-3/4	2	29.9
45	80B45	14.90	14.336	1-1/4	3-1/4	4-3/4	2	31.4
46	80B46	15.22	14.654	1-1/4	3-1/4	4-3/4	2	33.1
47	80B47	15.54	14.972	1-1/4	3-1/4	4-3/4	2	34.0
48	80B48	15.86	15.290	1-1/4	3-1/4	4-3/4	2	35.5
49	80B49	16.18	15.608	1-1/4	3-1/4	4-3/4	2	35.8
50	80B50	16.50	15.926	1-1/4	3-1/4	4-3/4	2	37.3
51	80B51	16.81	16.244	1-1/4	3-1/4	4-3/4	2	38.6
52	80B52	17.13	16.562	1-1/4	3-1/4	4-3/4	2	39.4
53	80B53	17.45	16.880	1-1/4	3-1/4	4-3/4	2	41.3
54	80B54	17.77	17.198	1-1/4	3-1/2	5-1/4	2	44.7
55	80B55	18.09	17.516	1-1/4	3-1/2	5-1/4	2	45.6
56	80B56	18.41	17.835	1-1/4	3-1/2	5-1/4	2	47.5
57	80B57	18.73	18.153	1-1/4	3-1/2	5-1/4	2	48.5
58	80B58	19.04	18.471	1-1/4	3-1/2	5-1/4	2	50.5
59	80B59	19.36	18.789	1-1/4	3-1/2	5-1/4	2	52.1
60	80B60	19.68	19.107	1-1/4	3-1/2	5-1/4	2	54.5
65	80B65	21.27	20.698	1-1/4	3-1/2	5-1/4	2	61.8

\*Has recessed groove in the hub for chain clearance.  
Sprockets with "H" prefix have hardened teeth.

**NOTE:** Maximum bores shown will accommodate a standard keyseat and a setscrew over the keyseat. Slightly larger bores are possible with no keyseat, a shallow keyseat, or a setscrew at an angle to the keyseat.