

80 Sprockets

1" Pitch

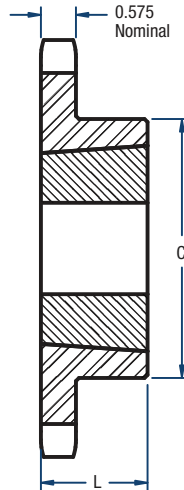

BLACKSTAR®



TYPE B

Single- TL Style

No. of Teeth	Catalog Number	Bushing	Diameters (in)		Type	Max. Bore	Dimensions (in)		Approx. Weight (lbs)	
			Outside	Pitch			L	C	Bushing Only	Sprocket Only
10	H80BTL10	1215	3.68	3.236	B	1-1/4	1-1/2	2-3/8*	0.8	1.1
11	H80BTL11	1215	4.01	3.550	B	1-1/4	1-1/2	2-15/32*	0.8	1.5
12	H80BTL12	1615	4.33	3.864	B	1-5/8	1-1/2	3*	1.2	1.8
13	H80BTL13	1615	4.66	4.179	B	1-5/8	1-1/2	3	1.2	2.3
14	H80BTL14	1615	4.98	4.494	B	1-5/8	1-1/2	3-1/4	1.2	2.5
15	H80BTL15	1615	5.30	4.810	B	1-5/8	1-1/2	3-1/4	1.2	2.7
16	H80BTL16	2012	5.63	5.126	B	2	1-1/4	3-9/16	1.7	2.8
17	H80BTL17	2012	5.95	5.442	B	2	1-1/4	3-9/16	1.7	3.1
18	H80BTL18	2012	6.27	5.759	B	2	1-1/4	3-9/16	1.7	3.6
19	H80BTL19	2012	6.59	6.076	B	2	1-1/4	3-9/16	1.7	4.1
20	H80BTL20	2517	6.91	6.392	B	2-1/2	1-3/4	4-1/4	3.5	5.5
21	H80BTL21	2517	7.24	6.710	B	2-1/2	1-3/4	4-1/4	3.5	6.0
22	H80BTL22	2517	7.56	7.027	B	2-1/2	1-3/4	4-1/4	3.5	6.5
23	H80BTL23	2517	7.88	7.344	B	2-1/2	1-3/4	4-1/4	3.5	7.0
24	H80BTL24	2517	8.20	7.661	B	2-1/2	1-3/4	4-1/4	3.5	7.5
25	H80BTL25	2517	8.52	7.979	B	2-1/2	1-3/4	4-1/4	3.5	8.1
26	H80BTL26	2517	8.84	8.296	B	2-1/2	1-3/4	4-1/4	3.5	8.8
27	H80BTL27	2517	9.16	8.614	B	2-1/2	1-3/4	4-1/4	3.5	9.0
28	H80BTL28	2517	9.48	8.931	B	2-1/2	1-3/4	4-1/4	3.5	9.5
30	H80BTL30	2517	10.11	9.567	B	2-1/2	1-3/4	4-1/4	3.5	11.5
32	80BTL32	2517	10.75	10.202	B	2-1/2	1-3/4	4-1/4	3.5	12.0
35	80BTL35	2517	11.71	11.156	B	2-1/2	1-3/4	4-1/4	3.5	15.2
36	80BTL36	2517	12.03	11.474	B	2-1/2	1-3/4	4-1/4	3.5	17.0
40	80BTL40	2517	13.31	12.746	B	2-1/2	1-3/4	4-1/4	3.5	21.0
45	80BTL45	2517	14.90	14.336	B	2-1/2	1-3/4	4-1/4	3.5	26.5
48	80BTL48	2517	15.86	15.290	B	2-1/2	1-3/4	4-1/4	3.5	29.5
54	80BTL54	2517	17.77	17.198	B	2-1/2	1-3/4	4-1/4	3.5	38.5
60	80BTL60	2517	19.68	19.107	B	2-1/2	1-3/4	4-1/4	3.5	45.0
70	80BTL70	3020	22.87	22.289	B	3	2	5-1/4	6.5	52.3
80	80BTL80	3020	26.05	25.471	B	3	2	5-1/4	6.5	69.2

*Has a recessed groove in the hub for chain clearance.
Sprockets with "H" prefix have hardened teeth.

NOTE: Maximum bores shown will accommodate a standard keyseat and a setscrew over the keyseat. Slightly larger bores are possible with no keyseat, a shallow keyseat, or a setscrew at an angle to the keyseat.