

80 Sprockets

1" Pitch

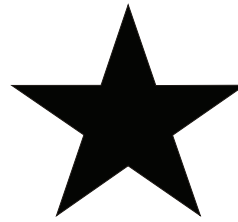

BLACKSTAR®

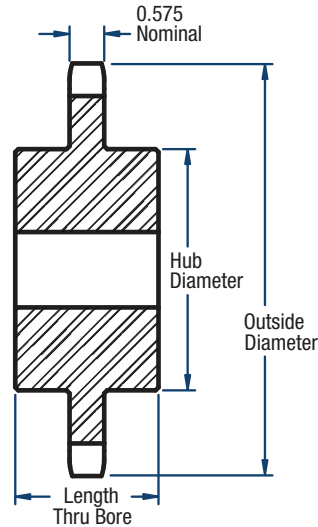

TYPE C

Single- Type C

No. of Teeth	Catalog Number	Diameters (in)		Bore		Hub (in)		Approx. Weight (lbs)
		Outside Diameter	Pitch Diameter	Minimum	Maximum	Diameter	Length Through Bore	
11	H80C11	4.01	3.550	1	1-5/8	2-29/32*	2-3/8	3.9
12	H80C12	4.33	3.864	1	1-7/8	3-1/8*	2-3/8	4.3
13	H80C13	4.66	4.179	1	2	3-1/64	2-3/8	5.3
14	H80C14	4.98	4.494	1	2-1/4	3-11/32	2-3/8	6.4
15	H80C15	5.30	4.810	1	2-1/2	3-13/16	2-3/8	7.8
16	H80C16	5.63	5.126	1	2-3/4	4	2-3/8	8.8
70	80C70	22.87	22.289	1-1/2	4-1/4	6-1/4	3-1/2	75.7
72	80C72	23.50	22.926	1-1/2	4-1/4	6-1/4	3-1/2	81.4
76	80C76	24.78	24.198	1-1/2	4-1/4	6-1/4	3-1/2	87.8
80	80C80	26.05	25.471	1-1/2	4-1/4	6-1/4	3-1/2	89.9
84	80C84	27.33	26.744	1-1/2	4-1/4	6-1/4	3-1/2	99.2
90	80C90	29.24	28.654	1-1/2	4-1/4	6-1/4	3-1/2	106.0
96	80C96	31.15	30.563	1-1/2	4-1/4	6-1/4	3-1/2	117.0
112	80C112	36.24	35.655	1-1/2	4-1/4	6-1/4	3-1/2	154.0

Sprockets with "H" prefix have hardened teeth.
Has recessed groove in the hub for chain clearance.

NOTE: Maximum bores shown will accommodate a standard keyseat and a setscrew over the keyseat. Slightly larger bores are possible with no keyseat, a shallow keyseat, or a setscrew at an angle to the keyseat.