

# D120 Sprockets

## 1 1/2" Pitch

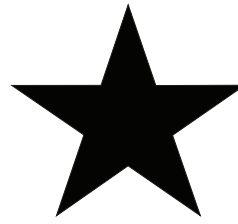

# BLACKSTAR®

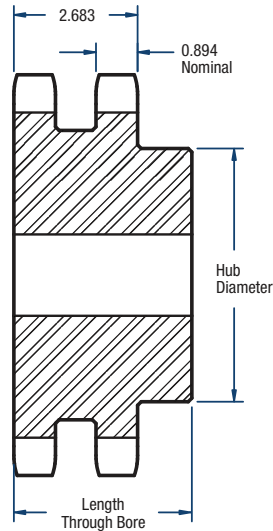

**TYPE B**

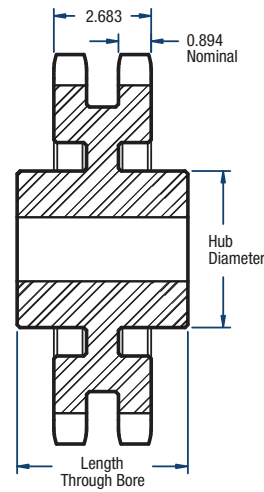

**TYPE C**

### Double- Type B and C

No. of Teeth	Catalog Number	Diameters (in)		Type	Bore (in)		Hub (in)		Approx. Weight (lbs)
		Outside	Pitch		Minimum	Maximum	Diameter	Length Through Bore	
11	D120B11H	6.01	5.325	B	1-1/2	2-3/8	3-9/16	3-3/4	13.6
12	D120B12H	6.50	5.796	B	1-1/2	2-3/4	4-1/16	3-3/4	17.3
13	D120B13H	6.99	6.269	B	1-1/2	3	4-1/2	3-3/4	21.1
14	D120B14H	7.47	6.741	B	1-1/2	3-5/16	5	3-3/4	25.6
15	D120B15H	7.96	7.215	B	1-1/2	3-1/2	5-1/4	3-3/4	29.9
16	D120B16H	8.44	7.689	B	1-1/2	3-1/2	5-1/4	3-3/4	33.8
17	D120B17H	8.92	8.163	B	1-1/2	3-1/2	5-1/4	3-3/4	36.9
18	D120B18H	9.41	8.639	B	1-1/2	3-1/2	5-1/4	3-3/4	41.9
19	D120B19H	9.89	9.114	B	1-1/2	3-1/2	5-1/4	3-3/4	46.5
20	D120B20H	10.37	9.588	B	1-1/2	3-1/2	5-1/2	3-3/4	50.2
21	D120B21H	10.85	10.065	B	1-1/2	3-1/2	5-1/2	3-3/4	55.6
22	D120B22H	11.33	10.541	B	1-1/2	3-13/16	5-3/4	4	64.0
23	D120B23H	11.81	11.016	B	1-1/2	4-1/2	6-1/2	4	75.0
24	D120B24H	12.29	11.492	B	1-1/2	4-1/2	6-1/2	4	79.0
25	D120B25H	12.77	11.969	B	1-1/2	4-1/2	6-1/2	4	84.0
26	D120B26H	13.25	12.444	B	1-1/2	4-1/2	6-1/2	4	90.0
30	D120B30H	15.17	14.351	B	1-1/2	4-1/2	6-1/2	4	119.0
35	D120C35	17.57	16.734	C	1-1/2	5-3/8	7-1/2	6	148.0
45	D120C45	22.35	21.504	C	1-1/2	5-3/8	7-1/2	6	188.0
60	D120C60	29.52	28.661	C	1-1/2	6-3/8	9-1/2	6-1/4	307.0

**NOTE:** Maximum bores shown will accommodate a standard keyseat and a setscrew over the keyseat. Slightly larger bores are possible with no keyseat, a shallow keyseat, or a setscrew at an angle to the keyseat.