

D140 Sprockets

1 3/4" Pitch

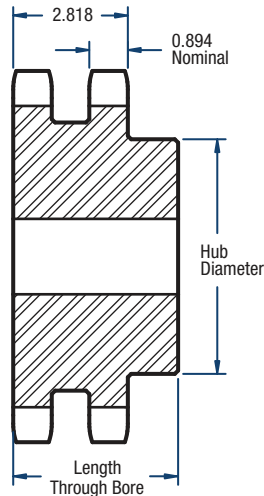

BLACKSTAR®



TYPE B

Double- Type B

No. of Teeth	Catalog Number	Diameters (in)		Bore (in)		Hub (in)		Approx. Weight (lbs)
		Outside	Pitch	Minimum	Maximum	Diameter	Length Through Bore	
13	D140B13H	8.15	7.313	1-5/8	3-5/16	5	3-3/4	29.0
14	D140B14H	8.72	7.865	1-5/8	3-3/4	5-1/2	3-3/4	34.8
15	D140B15H	9.28	8.418	1-5/8	4-1/2	6-1/2	3-3/4	42.5
16	D140B16H	9.85	8.971	1-5/8	5-1/4	7	4	48.1
17	D140B17H	10.41	9.524	1-5/8	5-1/4	7	4	57.5
18	D140B18H	10.97	10.078	1-3/4	5-1/4	7	4	65.6
19	D140B19H	11.54	10.633	1-3/4	5-1/4	7	4	72.0
20	D140B20H	12.10	11.186	1-3/4	5-1/4	7	4	76.0
21	D140B21H	12.66	11.743	1-3/4	5-1/4	7	4	82.0
22	D140B22H	13.22	12.297	1-3/4	5-1/4	7	4	94.0
23	D140B23H	13.78	12.852	1-3/4	5-1/4	7	4	100.0
24	D140B24H	14.34	13.407	1-3/4	5-1/4	7	4	104.0
25	D140B25H	14.90	13.963	1-3/4	5-1/4	7	4	120.0
26	D140B26H	15.46	14.518	1-3/4	5-1/4	7	4	128.0

NOTE: Maximum bores shown will accommodate a standard keyseat and a setscrew over the keyseat. Slightly larger bores are possible with no keyseat, a shallow keyseat, or a setscrew at an angle to the keyseat.