

# D140 Sprockets

## 1 3/4" Pitch

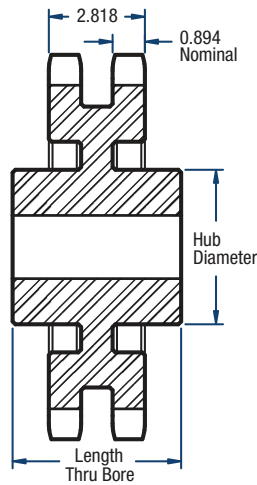

**TYPE C**

### Double- Type C

No. of Teeth	Catalog Number	Diameters (in)		Type	Bore (in)		Hub (in)		Approx. Weight (lbs)
		Outside	Pitch		Minimum	Maximum	Diameter	Length Through Bore	
35	D140C35	20.49	19.523	C	1-1/2	5-3/8	7-1/2	6	180.0
45	D140C45	26.08	25.088	C	1-1/2	5-3/8	7-1/2	6	232.0
60	D140C60	34.44	33.437	C	1-1/2	6-3/8	9-1/2	6-1/4	372.0

**NOTE:** Maximum bores shown will accommodate a standard keyseat and a setscrew over the keyseat. Slightly larger bores are possible with no keyseat, a shallow keyseat, or a setscrew at an angle to the keyseat.