

D160 Sprockets

2" Pitch

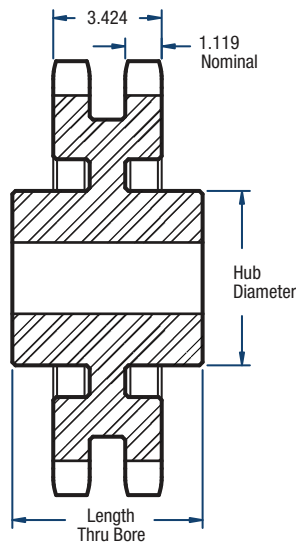

BLACKSTAR®



TYPE C

Double- Type C

No. of Teeth	Catalog Number	Diameters (in)		Bore (in)		Hub (in)		Approx. Weight (lbs)
		Outside	Pitch	Minimum	Maximum	Diameter	Length Through Bore	
35	D160C35	23.42	22.312	1-1/2	6-3/4	9-1/2	6-5/8	306.0
45	D160C45	29.80	28.672	1-1/2	7	10	7-1/8	431.0
60	D160C60	39.36	38.214	1-1/2	7	10	7-1/8	564.0

NOTE: Maximum bores shown will accommodate a standard keyseat and a setscrew over the keyseat. Slightly larger bores are possible with no keyseat, a shallow keyseat, or a setscrew at an angle to the keyseat.