

D200 Sprockets

2 1/2" Pitch

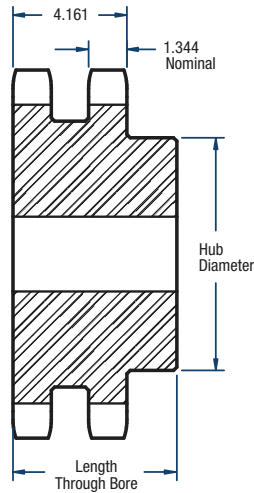

BLACKSTAR®



TYPE B

Double- Type B

No. of Teeth	Catalog Number	Diameters (in)		Bore (in)		Hub (in)		Approx. Weight (lbs)
		Outside	Pitch	Minimum	Maximum	Diameter	Length Through Bore	
11	D200B11H	10.02	8.872	2	3-3/4	5-1/2	5-7/8	57.0
12	D200B12H	10.83	9.660	2	4-1/2	6-1/2	6-1/4	80.0
13	D200B13H	11.64	10.447	2	5-1/4	7	6-3/8	96.0
14	D200B14H	12.46	11.235	2	5-1/2	8	6-3/8	119.0
15	D200B15H	13.26	12.025	2	5-3/4	8-1/2	6-3/8	138.0
16	D200B16H	14.07	12.815	2	5-3/4	8-1/2	6-5/8	161.0
17	D200B17H	14.87	13.605	2	5-3/4	8-1/2	6-5/8	178.0
18	D200B18H	15.68	14.397	2	5-3/4	8-1/2	6-5/8	196.0
19	D200B19H	16.48	15.190	2	5-3/4	8-1/2	6-5/8	217.0
20	D200B20H	17.29	15.980	2	5-3/4	8-1/2	6-5/8	236.0
21	D200B21H	18.09	16.775	2	5-3/4	8-1/2	6-5/8	250.0
22	D200B22H	18.89	17.567	2	5-3/4	8-1/2	6-5/8	284.0
23	D200B23H	19.69	18.360	2	5-3/4	8-1/2	6-5/8	308.0
24	D200B24H	20.49	19.153	2	5-3/4	8-1/2	6-5/8	330.0
25	D200B25H	21.29	19.947	2	5-3/4	8-1/2	6-5/8	358.0
26	D200B26H	22.09	20.740	2	5-3/4	8-1/2	6-5/8	386.0

NOTE: Maximum bores shown will accommodate a standard keyseat and a setscrew over the keyseat. Slightly larger bores are possible with no keyseat, a shallow keyseat, or a setscrew at an angle to the keyseat.