

D200 Sprockets

2 1/2" Pitch

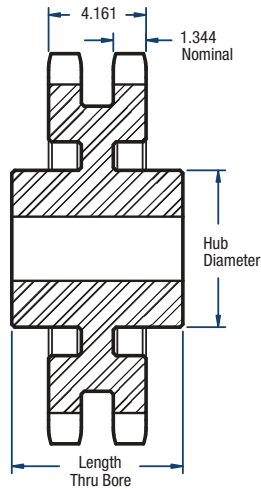

BLACKSTAR®



TYPE C

Double- Type C

No. of Teeth	Catalog Number	Diameters (in)		Bore (in)		Hub (in)		Approx. Weight (lbs)
		Outside	Pitch	Minimum	Maximum	Diameter	Length Through Bore	
45	D200C45	37.25	35.840	1-1/2	7	10	8-1/2	665.0
60	D200C60	49.20	47.768	1-1/2	7	10	9	972.0

NOTE: Maximum bores shown will accommodate a standard keyseat and a setscrew over the keyseat. Slightly larger bores are possible with no keyseat, a shallow keyseat, or a setscrew at an angle to the keyseat.