

D35 Sprockets

3/8" Pitch

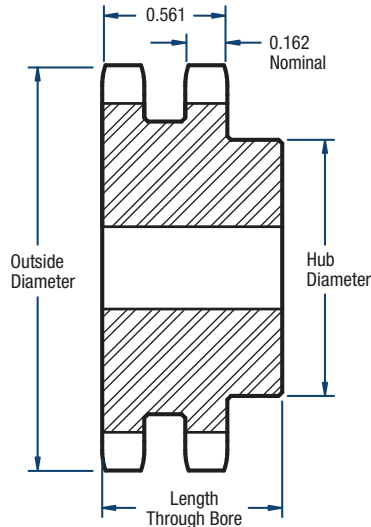

BLACKSTAR®



TYPE B

Double- Type B

No. of Teeth	Catalog Number	Diameters (in)		Bore (in)		Hub (in)		Approx. Weight (lbs)
		Outside	Pitch	Minimum	Maximum	Diameter	Length Through Bore	
12	D35B12H	1.63	1.449	1/2	9/16	63/64	1-1/4	0.32
13	D35B13H	1.75	1.567	1/2	11/16	1-7/64	1-1/4	0.36
14	D35B14H	1.87	1.685	1/2	7/8	1-1/4	1-1/4	0.44
15	D35B15H	1.99	1.804	1/2	15/16	1-13/32	1-1/4	0.56
16	D35B16H	2.11	1.922	1/2	15/16	1-15/32	1-1/4	0.64
17	D35B17H	2.23	2.041	1/2	1-1/16	1-19/32	1-1/4	0.74
18	D35B18H	2.35	2.160	1/2	1-3/16	1-23/32	1-1/4	0.84
19	D35B19H	2.47	2.279	1/2	1-5/16	1-7/8	1-1/4	0.96
20	D35B20H	2.59	2.397	3/4	1-5/16	1-15/16	1-3/8	1.08
21	D35B21H	2.71	2.516	3/4	1-3/8	2-1/16	1-3/8	1.24
22	D35B22H	2.83	2.635	3/4	1-7/16	2-3/16	1-3/8	1.42
23	D35B23H	2.95	2.754	3/4	1-1/2	2-1/4	1-3/8	1.54
24	D35B24H	3.07	2.873	3/4	1-1/2	2-1/4	1-3/8	1.62
25	D35B25H	3.19	2.992	3/4	1-1/2	2-1/4	1-3/8	1.66
26	D35B26H	3.31	3.111	3/4	1-3/4	2-1/2	1-3/8	1.98
30	D35B30H	3.79	3.588	3/4	1-3/4	2-1/2	1-3/8	2.34
36	D35B36	4.51	4.303	3/4	1-3/4	2-1/2	1-3/8	3.00
42	D35B42	5.23	5.018	3/4	1-3/4	2-1/2	1-3/8	3.80
48	D35B48	5.95	5.734	3/4	1-3/4	2-1/2	1-3/8	4.66
52	D35B52	6.43	6.211	3/4	1-3/4	2-1/2	1-3/8	5.40
60	D35B60	7.38	7.165	3/4	1-3/4	2-1/2	1-3/8	6.84
68	D35B68	8.34	8.120	3/4	2-3/8	3-1/2	1-1/2	10.01
72	D35B72	8.81	8.597	3/4	2-3/8	3-1/2	1-1/2	11.04
76	D35B76	9.29	9.074	3/4	2-3/8	3-1/2	1-1/2	11.94
84	D35B84	10.25	10.029	3/4	2-3/8	3-1/2	1-1/2	14.98
95	D35B95	11.56	11.342	1	2-3/8	3-1/2	1-1/2	17.42
96	D35B96	11.68	11.461	1	2-3/8	3-1/2	1-1/2	18.14
102	D35B102	12.40	12.177	1	2-3/8	3-1/2	1-1/2	19.92

*Has recessed groove in the hub for chain clearance.
Sprockets with "H" prefix have hardened teeth.

NOTE: Maximum bores shown will accommodate a standard keyseat and a setscrew over the keyseat. Slightly larger bores are possible with no keyseat, a shallow keyseat, or a setscrew at an angle to the keyseat.