

# DS40 Sprockets

## 1/2" Pitch

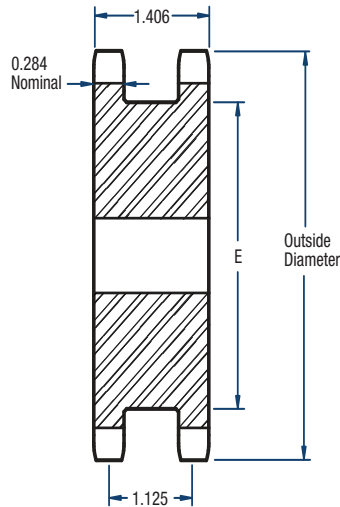

# BLACKSTAR®



TYPE A

### Double Single- Type A

No. of Teeth	Catalog Number	Diameters (in)		Bore (in)		E	Approx. Weight (lbs)
		Outside	Pitch	Min.	Max.		
15	DS40A15H	2.65	2.405	1/2	1-1/4	1-13/16	1.2
16	DS40A16H	2.81	2.563	1/2	1-1/4	2	1.4
17	DS40A17H	2.98	2.721	1/2	1-5/16	2-1/8	1.6
18	DS40A18H	3.14	2.879	1/2	1-1/2	2-5/16	1.8
19	DS40A19H	3.30	3.038	5/8	1-11/16	2-1/2	2.2
20	DS40A20H	3.46	3.196	5/8	1-3/4	2-5/8	2.6
21	DS40A21H	3.62	3.355	5/8	1-3/4	2-25/32	2.9
22	DS40A22H	3.78	3.513	5/8	1-13/16	2-15/16	3.0
23	DS40A23H	3.94	3.672	5/8	2-1/16	3-3/32	3.5
24	DS40A24H	4.10	3.831	5/8	2-1/4	3-17/64	4.0
25	DS40A25H	4.26	3.989	5/8	2-1/4	3-7/16	4.5

Sprockets with "H" suffix have hardened teeth.

**NOTE:** Maximum bores shown will accommodate a standard keyseat and a setscrew over the keyseat. Slightly larger bores are possible with no keyseat, a shallow keyseat, or a setscrew at an angle to the keyseat.