

# D50 Sprockets

## 5/8" Pitch

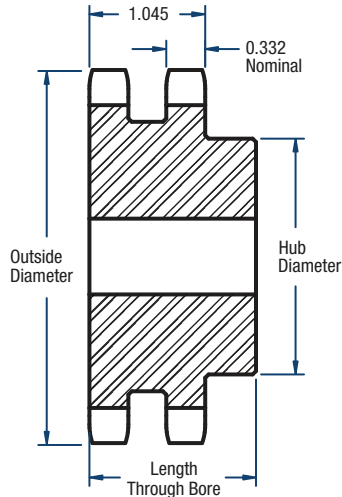

# BLACKSTAR®



**TYPE B**

### Double- Type B

No. of Teeth	Catalog Number	Diameters (in)		Bore (in)		Hub (in)		Approx. Weight (lbs)
		Outside	Pitch	Min.	Max.	Diameter	Length Through Bore	
11	D50B11H	2.50	2.219	5/8	15/16	1-15/32	1-3/4	1.0
12	D50B12H	2.71	2.415	5/8	1-1/8	1-11/16	1-3/4	1.3
13	D50B13H	2.91	2.612	5/8	1-5/16	1-7/8	1-3/4	1.6
14	D50B14H	3.11	2.809	5/8	1-3/8	2-1/16	1-3/4	1.9
15	D50B15H	3.32	3.006	3/4	1-1/2	2-5/16	1-3/4	2.2
16	D50B16H	3.52	3.204	3/4	1-3/4	2-1/2	1-3/4	2.6
17	D50B17H	3.72	3.401	3/4	1-7/8	2-11/16	1-3/4	3.0
18	D50B18H	3.92	3.599	3/4	1-15/16	2-15/16	1-3/4	3.6
19	D50B19H	4.12	3.798	1	2-1/8	3-1/8	1-3/4	3.9
20	D50B20H	4.32	3.995	1	2-1/4	3-1/4	1-3/4	4.3
21	D50B21H	4.52	4.194	1	2-3/8	3-1/2	1-3/4	4.9
22	D50B22H	4.72	4.392	1	2-3/8	3-9/16	1-7/8	5.6
23	D50B23H	4.92	4.590	1	2-1/2	3-5/8	1-7/8	6.1
24	D50B24H	5.12	4.788	1	2-1/2	3-5/8	1-7/8	6.5
25	D50B25H	5.32	4.987	1	2-1/2	3-5/8	1-7/8	6.9
26	D50B26H	5.52	5.185	1	2-1/2	3-3/4	1-7/8	7.5
30	D50B30H	6.32	5.979	1	2-1/2	3-3/4	1-7/8	9.4
32	D50B32	6.72	6.376	1	2-1/2	3-3/4	1-7/8	10.5
35	D50B35	7.32	6.973	1	2-1/2	3-3/4	1-7/8	12.3
36	D50B36	7.52	7.171	1-3/16	2-3/4	4	2-1/8	13.9
40	D50B40	8.32	7.966	1-3/16	2-3/4	4	2-1/8	16.5
42	D50B42	8.72	8.364	1-3/16	2-3/4	4	2-1/8	17.9
45	D50B45	9.31	8.960	1-3/16	2-3/4	4	2-1/8	20.3
48	D50B48	9.91	9.556	1-3/16	2-3/4	4-1/4	2-3/8	24.1
52	D50B52	10.71	10.351	1-3/16	2-3/4	4-1/4	2-3/8	27.4
54	D50B54	11.11	10.749	1-3/16	2-3/4	4-1/4	2-3/8	29.7
60	D50B60	12.30	11.942	1-5/16	3	4-1/2	2-3/8	35.9
68	D50B68	13.89	13.533	1-5/16	3	4-1/2	2-3/8	45.0
72	D50B72	14.69	14.329	1-5/16	3	4-1/2	2-3/8	50.2
76	D50B76	15.49	15.124	1-5/16	3	4-1/2	2-3/8	55.6
84	D50B84	17.08	16.715	1-5/16	3	4-1/2	2-3/8	61.6
95	D50B95	19.27	18.903	1-5/16	3	4-1/2	2-3/8	64.3
96	D50B96	19.47	19.102	1-5/16	3	4-1/2	2-3/8	67.4
102	D50B102	20.66	20.296	1-5/16	3	4-1/2	2-3/8	72.7
112	D50B112	22.65	22.284	1-5/16	3-5/16	5-1/4	2-3/8	90.2

**NOTE:** Maximum bores shown will accommodate a standard keyseat and a setscrew over the keyseat. Slightly larger bores are possible with no keyseat, a shallow keyseat, or a setscrew at an angle to the keyseat.