

D60 Sprockets

3/4" Pitch

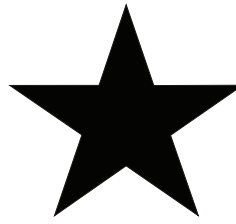

BLACKSTAR®

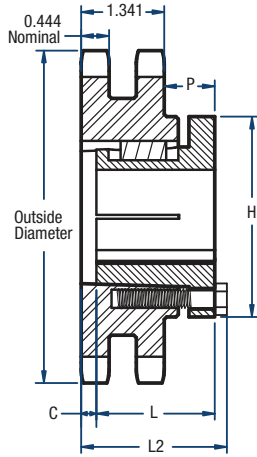

TYPE 12

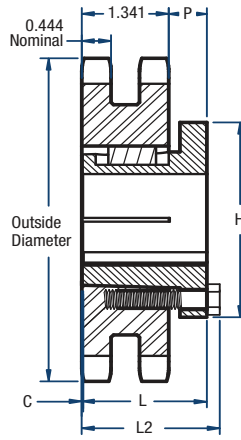

TYPE 13

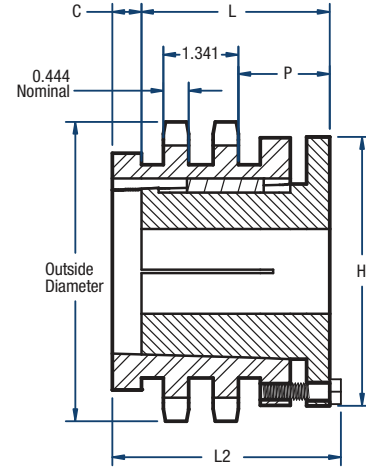

TYPE 16

Double-Split Taper Style

No. of Teeth	Catalog Number	Bushing	Diameters (in)		Type	Max. Bore	Dimensions (in)					Approx. Weight (lbs)	
			Outside Diameter	Pitch Diameter			L2	L	C	H	P	Bushing Only	Sprocket Only
13	D60P13H	P1	3.49	3.134	16	1 3/4	3-13/16	1-15/16	1-5/8	3	1-13/32	1.3	2.5
14	D60P14H	P1	3.74	3.371	12	1 3/4	3	1-15/16	13/16	3	1-13/32	1.3	2.3
15	D60P15H	P1	3.98	3.608	12	1 3/4	3	1-15/16	13/16	3	1-13/32	1.3	2.7
16	D60P16H	P1	4.22	3.845	13	1 3/4	2-7/32	1-15/16	1/32	3	5/8	1.3	2.4
17	D60P17H	P1	4.46	4.082	13	1 3/4	2-7/32	1-15/16	1/32	3	5/8	1.3	2.8
18	D60P18H	P1	4.70	4.319	13	1 3/4	2-7/32	1-15/16	1/32	3	5/8	1.3	3.4
19	D60P19H	P1	4.95	4.557	13	1 3/4	2-7/32	1-15/16	1/32	3	5/8	1.3	4.0
20	D60P20H	P1	5.19	4.794	13	1 3/4	2-7/32	1-15/16	1/32	3	5/8	1.3	4.7
21	D60Q21H	Q1	5.43	5.033	12	2 11/16	2-25/32	2-1/2	0	4-1/8	1-5/32	3.5	4.8
22	D60Q22H	Q1	5.67	5.270	12	2 11/16	2-25/32	2-1/2	0	4-1/8	1-5/32	3.5	5.6
23	D60Q23H	Q1	5.91	5.508	12	2 11/16	2-25/32	2-1/2	0	4-1/8	1-5/32	3.5	6.3
24	D60Q24H	Q1	6.15	5.746	12	2 11/16	2-25/32	2-1/2	0	4-1/8	1-5/32	3.5	7.0
25	D60Q25H	Q1	6.39	5.984	12	2 11/16	2-25/32	2-1/2	0	4-1/8	1-5/32	3.5	7.9
26	D60Q26H	Q1	6.63	6.222	12	2 11/16	2-25/32	2-1/2	0	4-1/8	1-5/32	3.5	8.8
27	D60Q27H	Q1	6.87	6.461	12	2 11/16	2-25/32	2-1/2	0	4-1/8	1-5/32	3.5	9.6
28	D60Q28H	Q1	7.11	6.698	12	2 11/16	2-25/32	2-1/2	0	4-1/8	1-5/32	3.5	10.5
30	D60Q30H	Q1	7.59	7.175	12	2 11/16	2-25/32	2-1/2	0	4-1/8	1-5/32	3.5	12.3
32	D60Q32	Q1	8.07	7.652	12	2 11/16	2-25/32	2-1/2	0	4-1/8	1-5/32	3.5	14.3
35	D60Q35	Q1	8.78	8.367	12	2 11/16	2-25/32	2-1/2	0	4-1/8	1-5/32	3.5	17.7
36	D60Q36	Q1	9.02	8.606	12	2 11/16	2-25/32	2-1/2	0	4-1/8	1-5/32	3.5	18.4
40	D60Q40	Q1	9.98	9.560	12	2 11/16	2-25/32	2-1/2	0	4-1/8	1-5/32	3.5	23.9
42	D60Q42	Q1	10.46	10.037	12	2 11/16	2-25/32	2-1/2	0	4-1/8	1-5/32	3.5	26.3
42	D60R42	R1	10.46	10.037	12	2 11/16	2-25/32	2-1/2	0	4-1/8	1-5/32	3.5	25.7
45	D60R45	R1	11.18	10.752	12	3 3/4	3-5/32	2-7/8	0	5-3/8	1-17/32	7.5	30.2
48	D60R48	R1	11.89	11.468	12	3 3/4	3-5/32	2-7/8	0	5-3/8	1-17/32	7.5	35.1
52	D60R52	R1	12.85	12.422	12	3 3/4	3-5/32	2-7/8	0	5-3/8	1-17/32	7.5	41.8
54	D60R54	R1	13.33	12.899	12	3 3/4	3-5/32	2-7/8	0	5-3/8	1-17/32	7.5	45.1
60	D60R60	R1	14.76	14.330	12	3 3/4	3-5/32	2-7/8	0	5-3/8	1-17/32	7.5	54.8
68	D60R68	R1	16.67	16.240	12	3 3/4	3-5/32	2-7/8	0	5-3/8	1-17/32	7.5	73.8
72	D60R72	R1	17.63	17.195	12	3 3/4	3-5/32	2-7/8	0	5-3/8	1-17/32	7.5	81.8
76	D60R76	R1	18.58	18.149	12	3 3/4	3-5/32	2-7/8	0	5-3/8	1-17/32	7.5	93.0
84	D60R84	R1	20.49	20.058	12	3 3/4	3-5/32	2-7/8	0	5-3/8	1-17/32	7.5	111.0
95	D60R95	R1	23.12	22.683	12	3 3/4	3-5/32	2-7/8	0	5-3/8	1-17/32	7.5	148.0
96	D60R96	R1	23.36	22.922	12	3 3/4	3-5/32	2-7/8	0	5-3/8	1-17/32	7.5	155.0

Sprockets with "H" suffix have hardened teeth.

NOTE: Maximum bores shown will accommodate a standard keyseat and a setscrew over the keyseat. Slightly larger bores are possible with no keyseat, a shallow keyseat, or a setscrew at an angle to the keyseat.