

DS80 Sprockets

1" Pitch

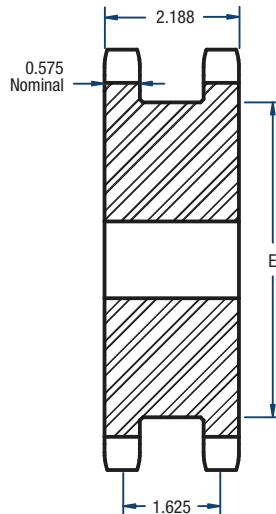

BLACKSTAR®



TYPE A

Double Single- Type A

| No. of Teeth | Catalog Number | Diameters (in) | | Bore (in) | | E | Approx. Weight (lbs) |
|--------------|----------------|----------------|-------|-----------|---------|---------|----------------------|
| | | Outside | Pitch | Min. | Max. | | |
| 13 | DS80A13H | 4.66 | 4.179 | 1 | 2 | 3-1/64 | 6.5 |
| 14 | DS80A14H | 4.98 | 4.494 | 1 | 2-1/4 | 3-11/32 | 7.7 |
| 15 | DS80A15H | 5.30 | 4.810 | 1 | 2-3/8 | 3-13/16 | 9.1 |
| 16 | DS80A16H | 5.63 | 5.126 | 1 | 2-11/16 | 4 | 9.5 |
| 17 | DS80A17H | 5.95 | 5.442 | 1 | 2-13/16 | 4-5/16 | 10.8 |
| 18 | DS80A18H | 6.27 | 5.759 | 1 | 3-1/8 | 4-41/64 | 12.1 |
| 19 | DS80A19H | 6.59 | 6.076 | 1 | 3-1/4 | 4-61/64 | 12.8 |
| 20 | DS80A20H | 6.91 | 6.392 | 1 | 3-1/2 | 5-9/32 | 14.0 |
| 21 | DS80A21H | 7.24 | 6.710 | 1 | 3-3/4 | 5-19/32 | 16.5 |
| 22 | DS80A22H | 7.56 | 7.027 | 1 | 3-7/8 | 5-59/64 | 18.4 |
| 23 | DS80A23H | 7.88 | 7.344 | 1 | 3-7/8 | 6-15/64 | 20.5 |

Sprockets with "H" suffix have hardened teeth.

NOTE: Maximum bores shown will accommodate a standard keyseat and a setscrew over the keyseat. Slightly larger bores are possible with no keyseat, a shallow keyseat, or a setscrew at an angle to the keyseat.