

D80 Sprockets

1" Pitch

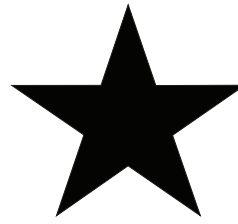

BLACKSTAR®

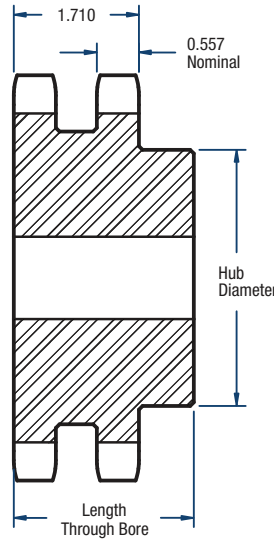

TYPE B

Double- Type B

No. of Teeth	Catalog Number	Diameters (in)		Bore (in)		Hub (in)		Approx. Weight (lbs)
		Outside	Pitch	Min.	Max.	Diameter	Length Through Bore	
10	D80B10H	3.68	3.236	1	1-1/2	2-9/16*	2-3/4	3.6
11	D80B11H	4.01	3.550	1	1-3/4	2-1/2	2-1/2	4.0
12	D80B12H	4.33	3.864	1	1-7/8	2-27/32	2-1/2	5.1
13	D80B13H	4.66	4.179	1	2-1/4	3-5/32	2-1/2	6.3
14	D80B14H	4.98	4.494	1	2-3/8	3-15/32	2-1/2	7.6
15	D80B15H	5.30	4.810	1	2-1/2	3-51/64	2-1/2	9.0
16	D80B16H	5.63	5.126	1	2-3/4	4	2-3/4	11.0
17	D80B17H	5.95	5.442	1	3	4-27/64	2-3/4	13.2
18	D80B18H	6.27	5.759	1	3-1/4	4-47/64	2-3/4	15.0
19	D80B19H	6.59	6.076	1	3-5/16	5	2-3/4	17.0
20	D80B20H	6.91	6.392	1	3-5/16	5	2-3/4	18.2
21	D80B21H	7.24	6.710	1	3-5/16	5	2-3/4	19.6
22	D80B22H	7.56	7.027	1	3-5/16	5	2-3/4	21.0
23	D80B23H	7.88	7.344	1	3-5/16	5	2-3/4	22.8
24	D80B24H	8.20	7.661	1	3-1/2	5-1/4	2-3/4	25.1
25	D80B25H	8.52	7.979	1	3-1/2	5-1/4	3	28.3
26	D80B26H	8.84	8.296	1	3-1/2	5-1/4	3	29.9
30	D80B30H	10.11	9.567	1-1/4	3-3/4	5-3/4	3	39.5
32	D80B32	10.75	10.202	1-1/4	3-3/4	5-3/4	3	43.8
35	D80B35	11.71	11.156	1-1/4	3-3/4	5-3/4	3	49.1
36	D80B36	12.03	11.474	1-1/4	3-3/4	5-3/4	3-1/8	54.2
42	D80B42	13.94	13.382	1-1/4	3-3/4	5-3/4	3-1/8	71.5
45	D80B45	14.90	14.336	1-1/4	3-3/4	5-3/4	3-1/8	73.5

*Has a recessed groove in the hub for chain clearance.
Sprockets with "H" suffix have hardened teeth.

NOTE: Maximum bores shown will accommodate a standard keyseat and a setscrew over the keyseat. Slightly larger bores are possible with no keyseat, a shallow keyseat, or a setscrew at an angle to the keyseat.