

D80 Sprockets

1" Pitch

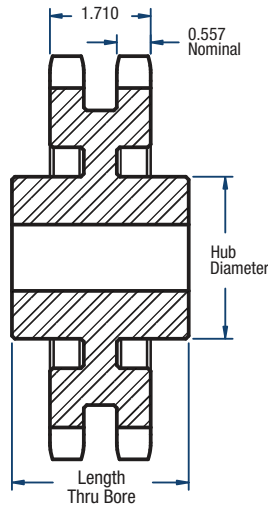
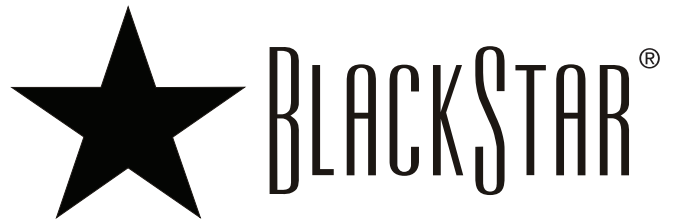

TYPE C

Double- Type C

No. of Teeth	Catalog Number	Diameters (in)		Type	Bore		Hub (in)		Approx. Weight (lbs)
		Outside Diameter	Pitch Diameter		Min.	Max.	Diameter	Length Through Bore	
52	D80C52	17.13	16.562	C	1-1/2	3-3/4	5-3/4	3-3/4	78.4
60	D80C60	19.68	19.107	C	1-1/2	3-3/4	5-3/4	3-3/4	93.3
68	D80C68	22.23	21.653	C	1-1/2	3-13/16	6	4	96.2
76	D80C76	24.78	24.198	C	1-1/2	3-13/16	6	4	113.0
95	D80C95	30.83	30.245	C	1-1/2	4	6	4-1/4	165.0

NOTE: Maximum bores shown will accommodate a standard keyseat and a setscrew over the keyseat. Slightly larger bores are possible with no keyseat, a shallow keyseat, or a setscrew at an angle to the keyseat.