

# DS40 Sprockets

## 1/2" Pitch

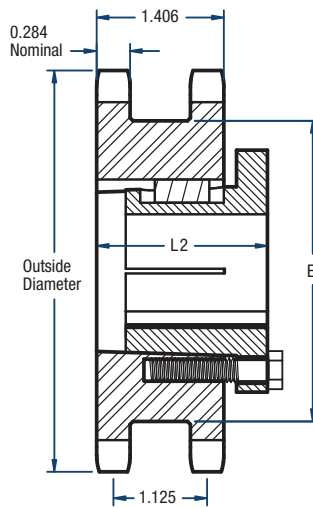

# BLACKSTAR®



**TYPE B**

### Double Single- Split Taper Style

No. of Teeth	Catalog Number	Bushing	Diameters (in)		Type	Bore		Dimensions (in)		Approx. Weight (lbs)	
			Outside Diameter	Pitch Diameter		Min.	Max.	E	L2	Bushing Only	Sprocket Only
19	DS40H19H	H	3.30	3.038	B	3/8	1-1/2	2-1/2	2-1/32	0.8	1.5
21	DS40H21H	H	3.62	3.355	B	3/8	1-1/2	2-25/32	2-1/32	0.8	2.0
23	DS40P23H	P1	3.94	3.672	B	1/2	1-3/4	3-3/32	2-9/32	1.3	2.3
24	DS40P24H	P1	4.10	3.831	B	1/2	1-3/4	3-17/64	2-9/32	1.3	2.5

Sprockets with "H" suffix have hardened teeth.

**NOTE:** Maximum bores shown will accommodate a standard keyseat and a setscrew over the keyseat. Slightly larger bores are possible with no keyseat, a shallow keyseat, or a setscrew at an angle to the keyseat.