

# DS50 Sprockets

## 5/8" Pitch

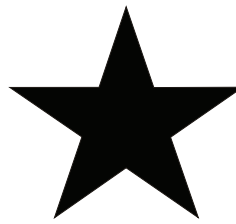

# BLACKSTAR®

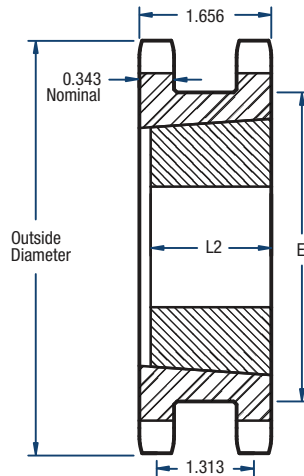

TYPE A

### Double Single- TL Style

No. of Teeth	Catalog Number	Bushing	Diameters (in)		Type	Bore (in)		Dimensions (in)		Approx. Weight (lbs)	
			Outside	Pitch		Min.	Max.	E	L2	Bushing Only	Sprocket Only
16	DS50ATL16H	1215	3.52	3.204	A	1/2	1-1/4	2-31/64	1.5	0.6	1.3
17	DS50ATL17H	1615	3.72	3.401	A	1/2	1-5/8	2-11/16	1.5	0.9	1.8
18	DA50ATL18H	1615	3.92	3.599	A	1/2	1-5/8	2-57/64	1.5	0.9	2.2
19	DS50ATL19H	1615	4.12	3.798	A	1/2	1-5/8	3-5/64	1.5	0.9	2.7
20	DS50ATL20H	1615	4.32	3.995	A	1/2	1-5/8	3-9/32	1.5	0.9	3.0
21	DS50ATL21H	2012	4.52	4.194	A	1/2	2	3-15/16	1.25	1.4	3.3
23	DS50ATL23H	2012	4.92	4.590	A	1/2	2	3-57/64	1.25	1.4	3.7
24	DS50ATL24H	2012	5.12	4.788	A	1/2	2	4-5/64	1.25	1.4	4.1

Sprockets with "H" suffix have hardened teeth.

**NOTE:** Maximum bores shown will accommodate a standard keyseat and a setscrew over the keyseat. Slightly larger bores are possible with no keyseat, a shallow keyseat, or a setscrew at an angle to the keyseat.