

# DS60 Sprockets

## 3/4" Pitch

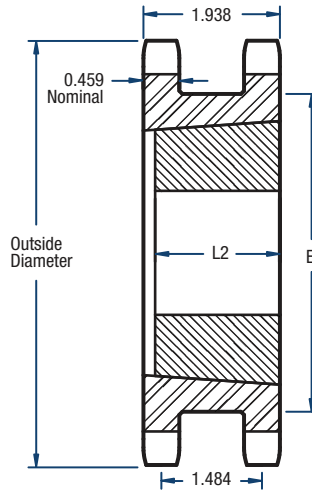

# BLACKSTAR®



TYPE A

### Double Single- TL Style

No. of Teeth	Catalog Number	Bushing	Diameters (in)		Type	Bore (in)		Dimensions (in)		Approx. Weight (lbs)	
			Outside	Pitch		Min.	Max.	E	L2	Bushing Only	Sprocket Only
16	DS60ATL16H	1615	4.22	3.845	A	1/2	1-5/8	2-63/64	1-1/2	0.9	4.2
17	DS60ATL17H	1615	4.46	4.082	A	1/2	1-5/8	3-7/32	1-1/2	0.9	4.5
18	DS60ATL18H	2012	4.70	4.319	A	1/2	2	3-15/32	1-1/4	1.4	5.0
19	DS60ATL19H	2012	4.95	4.557	A	1/2	2	3-45/64	1-1/4	1.4	5.8
20	DS60ATL20H	2517	5.19	4.794	A	1/2	2-1/2	3-61/64	1-3/4	3.0	5.6
21	DS60ATL21H	2517	5.43	5.033	A	1/2	2-1/2	4-3/16	1-3/4	3.0	6.4
23	DS60ATL23H	2517	5.91	5.508	A	1/2	2-1/2	4-43/64	1-3/4	3.0	7.3
24	DS60ATL24H	2517	6.15	5.746	A	1/2	2-1/2	4-29/32	1-3/4	3.0	8.2

Sprockets with "H" suffix have hardened teeth.

**NOTE:** Maximum bores shown will accommodate a standard keyseat and a setscrew over the keyseat. Slightly larger bores are possible with no keyseat, a shallow keyseat, or a setscrew at an angle to the keyseat.