

DS60 Sprockets

3/4" Pitch

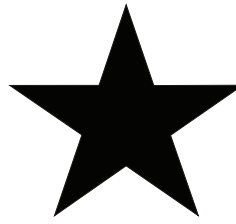

BLACKSTAR®

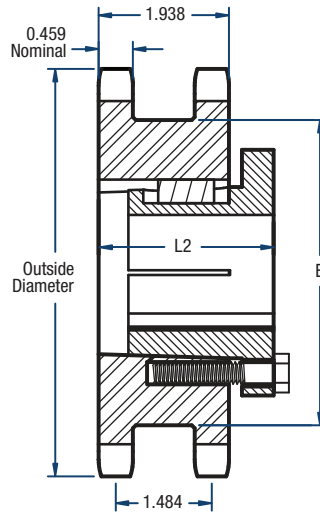

TYPE B

Double Single- Split Taper Style

No. of Teeth	Catalog Number	Bushing	Diameters (in)		Type	Bore (in)		Dimensions (in)		Approx. Weight (lbs)	
			Outside	Pitch		Min.	Max.	E	L2	Bushing Only	Sprocket Only
17	DS60P17H	P1	4.46	4.082	B	1/2	1-3/4	3-7/32	2-5/8	1.3	3.9
19	DS60P19H	P1	4.95	4.557	B	1/2	1-3/4	3-45/64	2-5/8	1.3	5.3
21	DS60Q21H	Q1	5.43	5.033	B	3/4	2-11/16	4-3/16	2-3/4	3.5	5.4
22	DS60Q22H	Q1	5.67	5.270	B	3/4	2-11/16	4-27/64	2-3/4	3.5	6.2
23	DS60Q23H	Q1	5.91	5.508	B	3/4	2-11/16	4-43/64	2-3/4	3.5	6.9
24	DS60Q24H	Q1	6.15	5.746	B	3/4	2-11/16	4-29/32	2-3/4	3.5	7.6

Sprockets with "H" suffix have hardened teeth.

NOTE: Maximum bores shown will accommodate a standard keyseat and a setscrew over the keyseat. Slightly larger bores are possible with no keyseat, a shallow keyseat, or a setscrew at an angle to the keyseat.