

DS80 Sprockets

1" Pitch

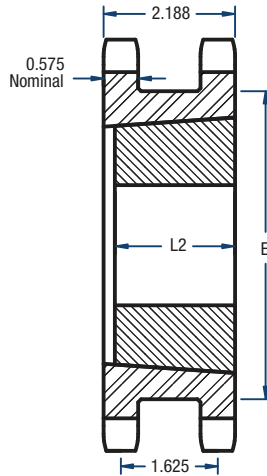

BLACKSTAR®



TYPE A

Double Single- TL Style

No. of Teeth	Catalog Number	Bushing Size	Diameters (in)		Type	Bore (in)		Dimensions (in)		Approx. Weight (lbs)	
			Outside	Pitch		Min.	Max.	E	L2	Bushing Only	Sprocket Only
17	DS80ATL17H	2517	5.95	5.442	A	1/2	2-1/2	4-5/16	1-3/4	3.0	7.6
18	DS80ATL18H	2517	6.27	5.759	A	1/2	2-1/2	4-3/4	1-3/4	3.0	8.7
19	DS80ATL19H	3020	6.59	6.076	A	15/16	3	4-61/64	2	5.4	9.7
20	DS80ATL20H	3020	6.91	6.392	A	15/16	3	5-9/32	2	5.4	10.0
21	DS80ATL21H	3020	7.24	6.710	A	15/16	3	5-19/32	2	5.4	12.0
22	DS80ATL22H	3020	7.56	7.027	A	15/16	3	5-59/64	2	5.4	13.0
23	DS80ATL23H	3020	7.88	7.344	A	15/16	3	6-15/64	2	5.4	14.5

Sprockets with "H" suffix have hardened teeth.

NOTE: Maximum bores shown will accommodate a standard keyseat and a setscrew over the keyseat. Slightly larger bores are possible with no keyseat, a shallow keyseat, or a setscrew at an angle to the keyseat.