

DS80 Sprockets

1" Pitch

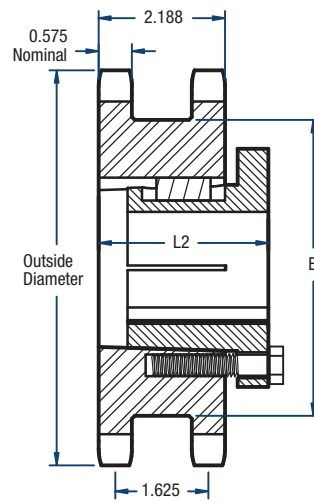

BLACKSTAR®



TYPE B

Double Single- Split Taper Style

No. of Teeth	Catalog Number	Bushing Size	Diameters (in)		Type	Bore (in)		Dimensions (in)		Approx. Weight (lbs)	
			Outside	Pitch		Min.	Max.	E	L2	Bushing Only	Sprocket Only
17	DS80Q17H	Q1	5.95	5.442	B	3/4	2-11/16	4-5/16	3-15/64	3.5	7.2
19	DS80Q19H	Q1	6.59	6.076	B	3/4	2-11/16	4-61/64	3-15/64	3.5	10.5
20	DS80Q20H	Q1	6.91	6.392	B	3/4	2-11/16	5-9/32	3-15/64	3.5	12.2
21	DS80R21H	R1	7.24	6.710	B	1-1/8	3-3/4	5-19/32	3-23/64	7.5	12.8
23	DS80R23H	R1	7.88	7.344	B	1-1/8	3-3/4	6-15/64	3-23/64	7.5	13.3

Sprockets with "H" suffix have hardened teeth.

NOTE: Maximum bores shown will accommodate a standard keyseat and a setscrew over the keyseat. Slightly larger bores are possible with no keyseat, a shallow keyseat, or a setscrew at an angle to the keyseat.