

# 200 Sprockets

## 2 1/2" Pitch

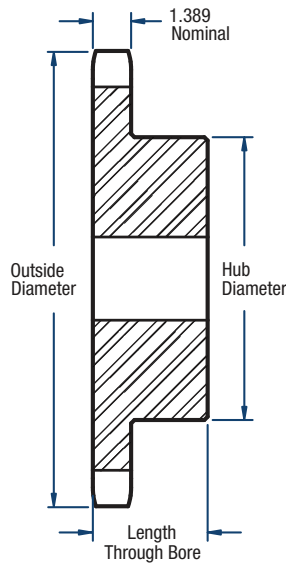

# BLACKSTAR®



**TYPE B**

### Single- Type B

No. of Teeth	Catalog Number	Diameters (in)		Bore (in)		Hub (in)		Approx. Weight (lbs)
		Outside	Pitch	Minimum	Maximum	Diameter	Length Through Bore	
10	H200B10	9.20	8.090	1-1/2	3-3/4	5-1/2	3	26.0
11	H200B11	10.02	8.872	1-1/2	4	6	3	33.0
12	H200B12	10.83	9.660	1-1/2	4-1/2	6-1/2	3	37.0
13	H200B13	11.64	10.447	1-1/2	5-1/4	7	3	46.0
14	H200B14	12.46	11.235	1-1/2	5-3/8	7-1/2	3-1/2	59.0
15	H200B15	13.26	12.025	1-1/2	5-3/8	7-1/2	3-1/2	64.0
16	H200B16	14.07	12.815	1-1/2	5-3/8	7-1/2	3-1/2	72.0
17	H200B17	14.87	13.605	1-1/2	5-3/8	7-1/2	3-1/2	76.0
18	H200B18	15.68	14.397	1-1/2	5-3/8	7-1/2	3-1/2	84.0
19	H200B19	16.48	15.190	1-1/2	5-3/8	7-1/2	3-1/2	91.0
20	H200B20	17.29	15.980	1-1/2	5-3/8	7-1/2	3-1/2	98.0
21	H200B21	18.09	16.775	1-1/2	5-3/8	7-1/2	3-1/2	106.0
22	H200B22	18.89	17.567	1-1/2	5-3/4	8-1/2	4	131.0
23	H200B23	19.69	18.360	1-1/2	5-3/4	8-1/2	4	136.0
24	H200B24	20.49	19.153	1-1/2	5-3/4	8-1/2	4	142.0
25	H200B25	21.29	19.947	1-1/2	5-3/4	8-1/2	4	153.0
26	H200B26	22.09	20.740	1-1/2	5-3/4	8-1/2	4-1/2	178.0
28	H200B28	23.69	22.330	1-1/2	5-3/4	8-1/2	4-1/2	195.0
30	H200B30	25.29	23.917	1-1/2	5-3/4	8-1/2	4-1/2	212.0
32	200B32	26.88	25.505	1-1/2	5-3/4	8-1/2	4-1/2	220.0
35	200B35	29.28	27.890	1-1/2	5-3/4	8-1/2	4-1/2	254.0
40	200B40	33.27	31.865	1-1/2	6	9	5	320.0
45	200B45	37.25	35.840	1-1/2	6	9	5	364.0
54	200B54	44.42	42.995	1-1/2	6-1/2	9-1/2	5-1/2	512.0
60	200B60	49.20	47.768	1-1/2	6-1/2	9-1/2	5-1/2	654.0

**NOTE:** Maximum bores shown will accommodate a standard keyseat and a setscrew over the keyseat. Slightly larger bores are possible with no keyseat, a shallow keyseat, or a setscrew at an angle to the keyseat.