

240 Sprockets

3" Pitch

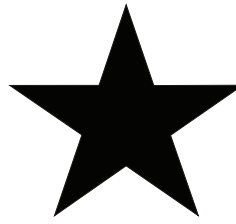

BLACKSTAR®

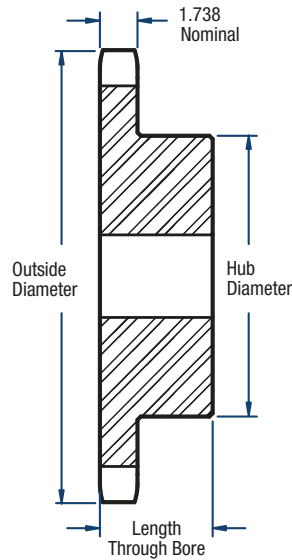

TYPE B

Single- Type B

No. of Teeth	Catalog Number	Diameters (in)		Bore (in)		Hub (in)		Approx. Weight (lbs)
		Outside	Pitch	Minimum	Maximum	Diameter	Length Through Bore	
10	H240B10	11.03	9.708	1-1/2	4-1/2	6-1/2	3-3/8	49.0
11	H240B11	12.02	10.649	1-1/2	4-3/4	7	3-7/8	66.0
12	H240B12	13.00	11.591	1-1/2	5-3/8	7-1/2	3-7/8	72.0
13	H240B13	13.97	12.536	1-1/2	5-3/8	7-1/2	3-7/8	81.0
14	H240B14	14.94	13.482	1-1/2	5-3/8	7-1/2	3-7/8	88.0
15	H240B15	15.91	14.429	1-1/2	5-3/8	7-1/2	3-7/8	98.0
16	H240B16	16.88	15.377	1-1/2	5-1/2	8	4-1/8	120.0
17	H240B17	17.85	16.327	1-1/2	5-1/2	8	4-1/8	137.0
18	H240B18	18.81	17.276	1-1/2	5-1/2	8	4-1/8	142.0
19	H240B19	19.78	18.227	1-1/2	5-1/2	8	4-1/8	154.0
20	H240B20	20.74	19.177	1-1/2	5-1/2	8	4-1/8	169.0
21	H240B21	21.71	20.129	1-1/2	5-1/2	8	4-1/8	186.0
25	H240B25	25.55	23.936	1-1/2	5-1/2	8	4-1/8	254.0

NOTE: Maximum bores shown will accommodate a standard keyseat and a setscrew over the keyseat. Slightly larger bores are possible with no keyseat, a shallow keyseat, or a setscrew at an angle to the keyseat.